

MILLARD

CARAVANS



Your ticket to *freedom* since 1947



2024 Range

TOURA



The trusted name in Australia for over 75 years

Australian Made · Australian Owned · Australian Tough · For Over 70 years

From humble beginnings in a small factory located in Mortlake, NSW to today, Millard Caravans is one of Australia's most respected and highly regarded caravans with a **proven track record since 1947**. After all this time we're still one of the best caravan manufacturers in Australia, with all Millard Caravans hand-built in our factory in Sydney.

We pride ourselves on **value for money**. We make sure our caravans have everything you need, plus that little extra luxury that you deserve. **Quality** is at the core of everything we do. We only work with the best of the best and source the highest quality materials, finishes and appliances, just for you.

Our **customer service** is what sets us apart. We're always finding ways to put you first and help you to make the best decisions so we can build your dream caravan together. Using **cutting edge manufacturing** technics and materials, our architecturally designed caravans are built to reflect your tastes and the lifestyle you want to live.

5 year Structural + 2 year Manufacturing warranty

All Millard Caravans are built to last with a hot dipped galvanised chassis, an Aluminium structural wall frame and full piece composite roof.

This gives you peace of mind in the longevity of the life of your quality-built Millard caravan which is backed by our commitment and promise of a 5 year Structural and 2 year Manufacturing warranty*.

Millard Caravans are accredited by RVMAP, the official accreditation key of the caravan industry. The RVMAP accreditation key is a symbol of a manufacturer's commitment to consistently build and supply quality products that adhere to all relevant Australian design rules, regulations and standards.

Millard Caravans was granted vehicle approval on the 27th June 2022 by the Department of Infrastructure, Transport and Regional Department and Communication.

The significance of this approval means that our entire range; MFLOW, TOURA, and BREAKAWAY are fully compliant to Australian Design Rules (ADR).

Millard Caravans VTA (Vehicle Type Approval) VTA-060501

*Warranty period commences from the date of purchase and is effective for all new caravans built from January 2020 onwards. Terms and Conditions apply.



TOURA

The Toura range

The semi off-road Toura is Millard's latest range, designed for families and couples looking for a feature-packed van at an affordable price.

Built with our signature hot-dipped galvanised chassis, single-sheet roof, independent CRS suspension and aluminium frame, the Toura's uncompromising quality makes it the ultimate companion on your family holidays.

Toura comes with more standard features eliminating the need to add-on options. Select upgrades and styling options are available across our standardised couple, pop-top, and bunk models.



Toura 18ft

Exterior

Built with our signature hot-dipped galvanised chassis, honeycomb floor, single-sheet roof, aluminium frame and CRS suspension, the Toura has been designed for the explorer who wants to travel endless dirt roads in the Australian outback.

The Toura will take you places remote and surreal without sacrificing any comfort as the list of inclusions is endless. All Toura's are fitted with 2x 200w Solar Panels, External Awning, Reversing Camera, Toolbox, External speakers and External shower.

To ensure we have done everything that we possibly can to keep yourself and passengers safe in an emergency, all Millard Toura models are also fitted with AI-ko electronic stability control (ESC).

To ensure there are plenty of extras, Millard Caravans now include 3x Annexe lights on door side and 1 on the driver side, plus front and rear LED bar lights. The tunnel boot is galvanised sheeted with drainage on both sides. The rear includes external shower and TV locker on the door side.

High black checkerplate and the high ground clearance from the CRS suspension ensures easy towing and protects your investment from the harsh rugged conditions during your travels.

For a full list of all standard inclusions and options please view the Specifications list in the back of this brochure. Exterior decals on all Toura models can be selected in one of four specially designed colour schemes.

Exterior Decal Options

Red

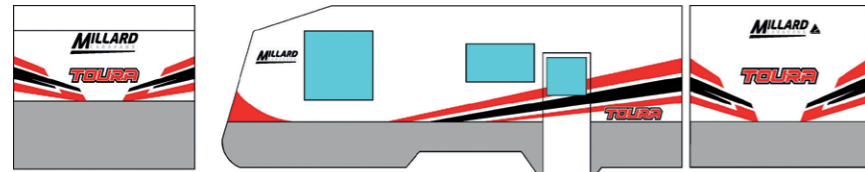

Gold

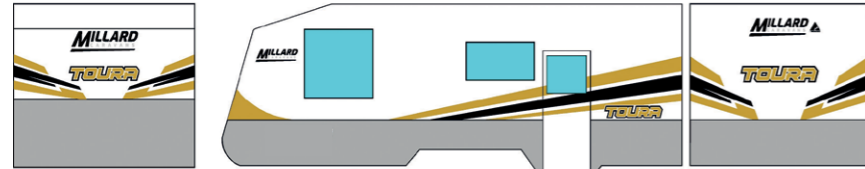

Blue

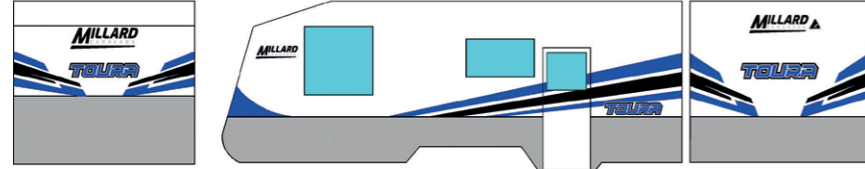

Silver

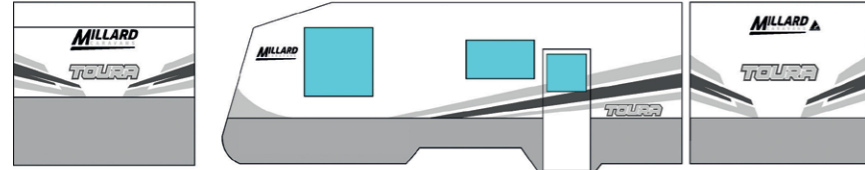

Exterior Panel Options

White



Dark Grey



Silver



Charcoal



Honeycomb Floor

Millard's new Toura now comes with a Honeycomb floor which is made from a thermoplastic composite sandwich panel consisting of polypropylene-honeycomb and fibreglass reinforced polypropylene face sheets.

They are joined together by a unique welding lamination process that creates an almost indestructible material.

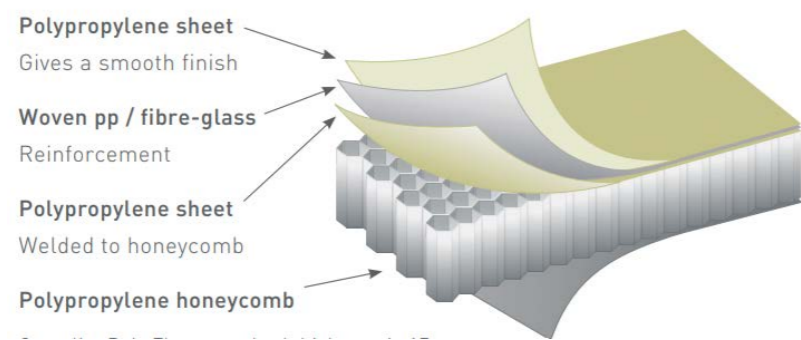

Benefits

- Lighter than Marine Ply by 30%
- Lighter caravan = lighter to tow, reducing fuel consumption
- Improved quality & durability delivering a longer lasting caravan
- Impervious to water, unaffected by salt water & other elements
- Easy to maintain
- Environmentally friendly as the floor can be reused or recycled



Although Millard caravans are known for its famous DNA (Hot Dipped Gavanised Chassis, Aluminium Frame and One-Piece Roof), they are designed to please with their spacious layouts & high end finishes.

With all these features in place, Millard Caravans also ensures you have the latest in electrical industry-leading power.

Millard's Toura caravans now come with lithium batteries, more solar units and BMPRO's Battery Plus 35-1-HA Management system and Odyssey display tablet.



Toura standard specification includes;

- BMPRO Battery Plus 35-1-HA
- BMPRO Odyssey Display Monitor
- 2x 120AH Lithium Batteries
- 2x 200W Solar Panels
- 2x Water Tank feeders with 2 dipper water level indicators
- Odyssey Link 104 & Miniboost DC-DC charger 20amps



Battery Management System

Interior

Millard Caravans have been designed with high quality interior finishes, using the best materials to give our caravans a high end finish.

Millard pride ourselves for our unique, spacious layouts combined with large windows for abundant natural light. The Dometic high quality windows allow you to see out while also providing you with privacy also reducing sun glare and eliminate unwanted heat loss or gain.



19ft 6 RD – Dinette



19ft 6 RD – Curved Benchtop



19ft 6 RD – Dinette Seating

The Toura range features Airconditioning, Full oven, Front loader washing machine, TV (24" to 27" layout dependant), Radio and Speakers, Microwave and 3-way 188-224lt (model dependant) fridges.

Further to all of these features, the Millard Toura is also equipped with a diesel heater for extra comfort in winter.



Toura Ensuite

Interior

Toura 19ft 6 – Rear Door (RD)



Spacious Layout



Dinette Seating

Exterior



Battery Box



Metal Tunnel boot door

Toura 20ft 6 – Family Van



L-Lounge Seating



Triple Bunk



BF Goodrich (Optional)

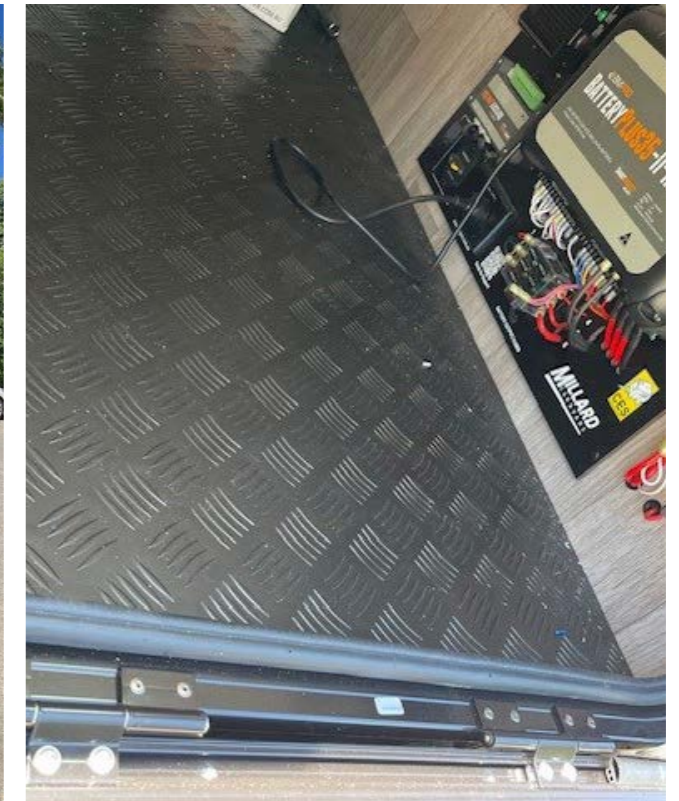

Tunnel Boot lining

Interior Schemes

Design 1

Soft and Serene. The light grey cabinetry creates an open plan against the strong contrasting backdrop colours.

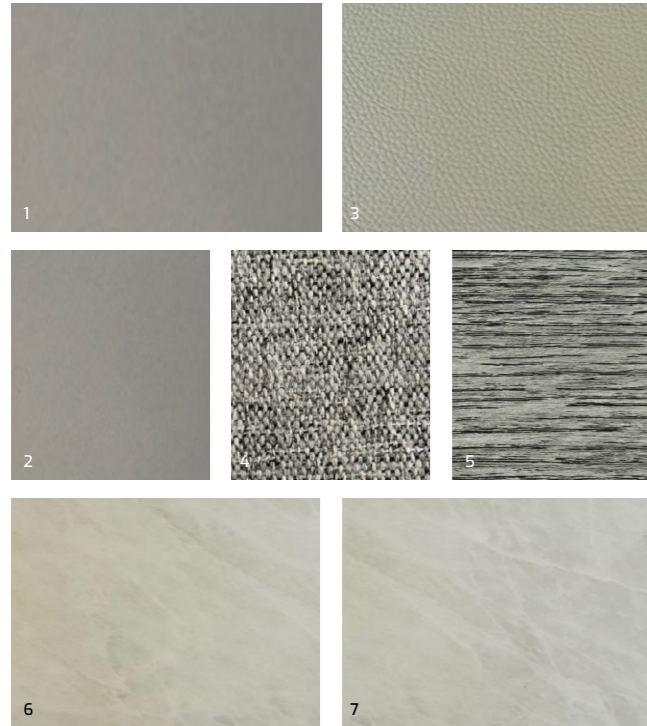

Design 2

Peaceful Secure Sanctuary. The platinum cabinetry creates warmth and comfort against the diverse surrounding colours

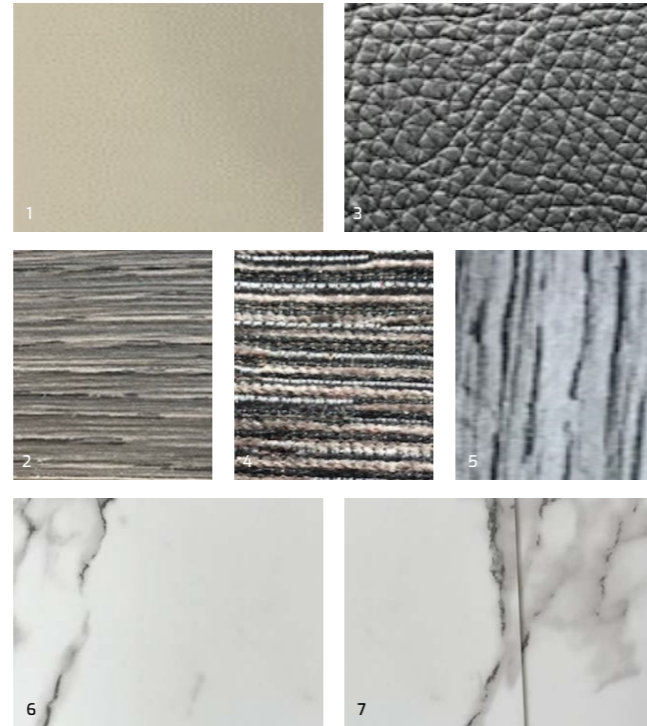

Design 5

Fresh and Rich. The transformation from a crisp white to a textured brown creates warmth to an inviting space

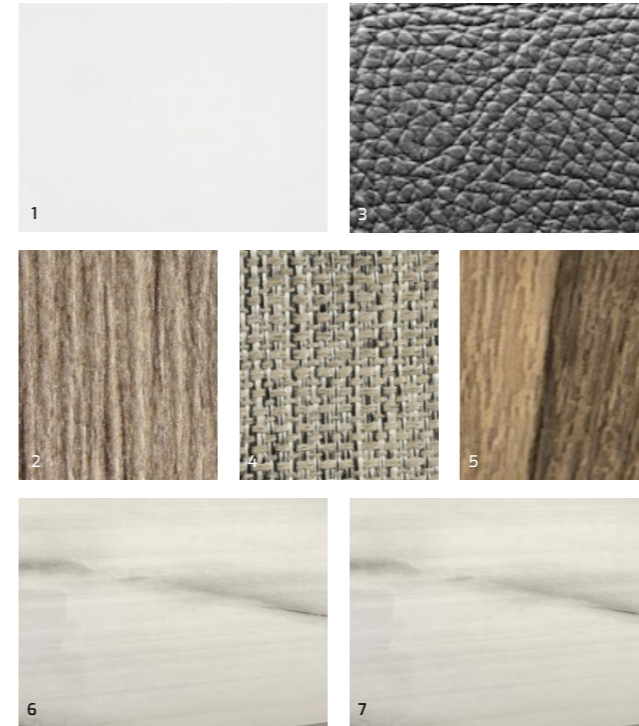

Design 6

Versatile and Contemporary: Soft white with the dark warm grey creates a seamless spacious feel and look.

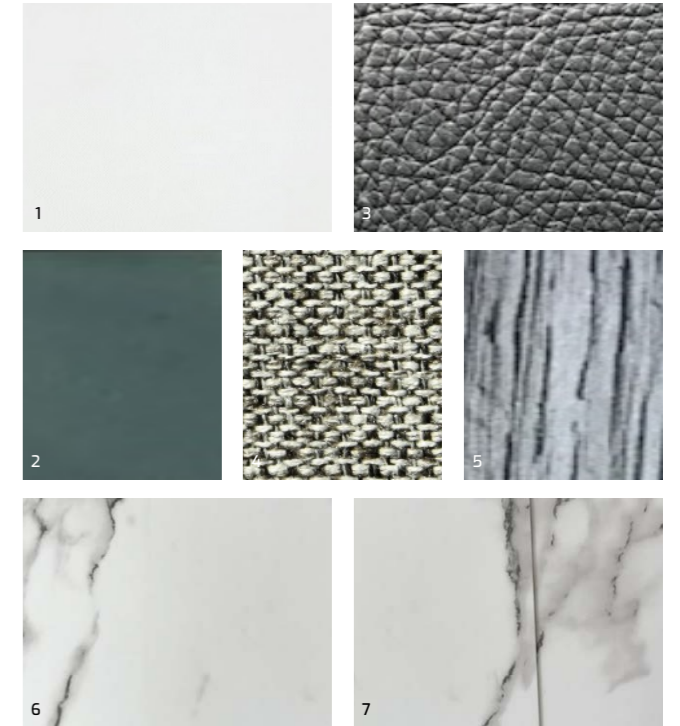

Design 3

Minimalist Edge. The classic look is created by pairing of the soft white cabinetry against the charcoal or black upholstery.

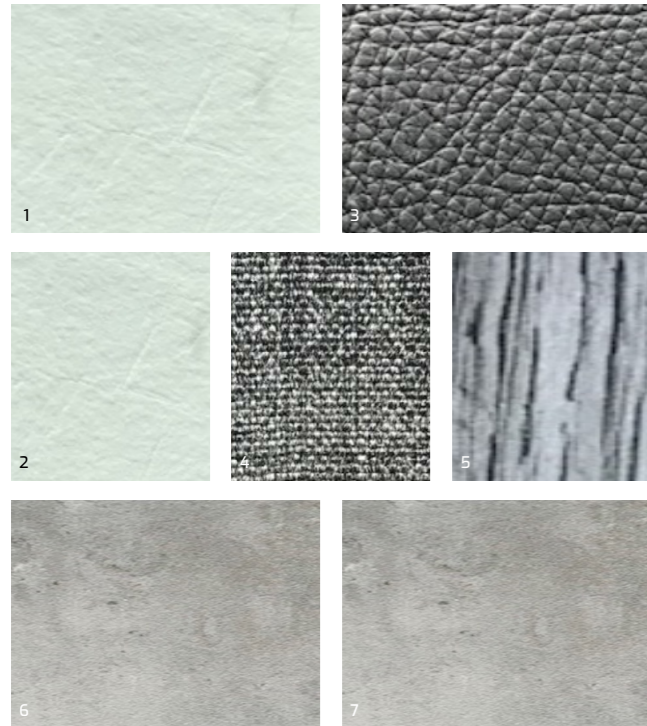

Design 4

Classic Ambience. The soft creams and browns create a cosy space for a neutral and relaxing setting

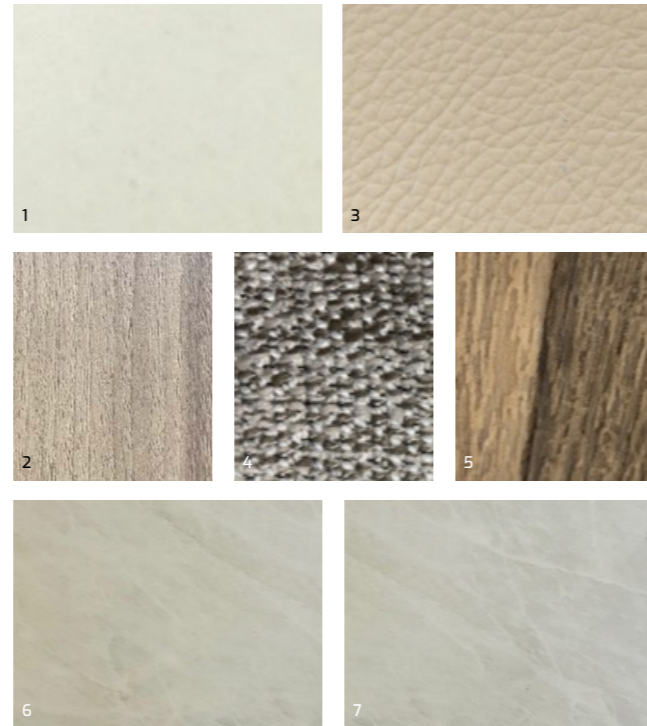

Design 7

Natural Delight. Classic ambience of the beige colours creates warmth and the desire to slow down.



- Key
- 1. Cabinetry Doors Top
 - 2. Cabinetry Doors Bottom
 - 3. Upholstery PU Leather Option
 - 4. Upholstery Fabric Option
 - 5. Flooring
 - 6. Kitchen & Vanity Splashback
 - 7. Kitchen & Vanity Benchtop
 - 8. Kitchen & Vanity Benchtop

Interior Schemes

- Note 1. Cabinetry Doors Bottom presets the Fridge/Microwave cabinetry colour.
 Note 2. Cabinetry Doors Top presets the Bedroom cabinetry colour (All doors Top + Bottom).
 Note 3. Cabinetry Doors Top presets the Bathroom Vanity & Overhead cabinetry colour (All doors Top + Bottom).
- Colourways: Please note you can mix and match colours from the 8 options. Ideally the recommendations from Millards designer team should be followed. Please note colour variations occur from batch to batch and from the presented images

Toura 16ft 9

Centre Door (CD)

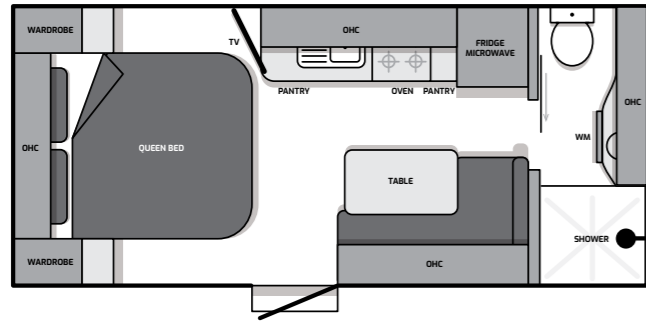

Rear Door (RD)



Toura 17ft 6

Centre Door (CD)

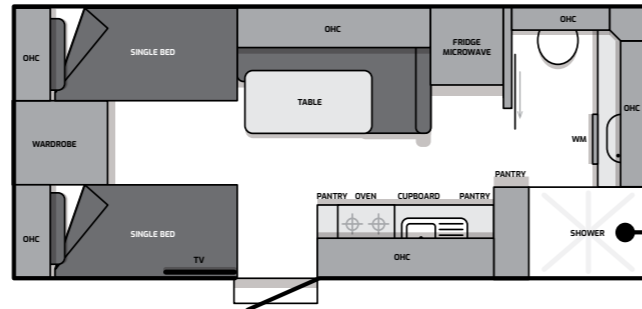
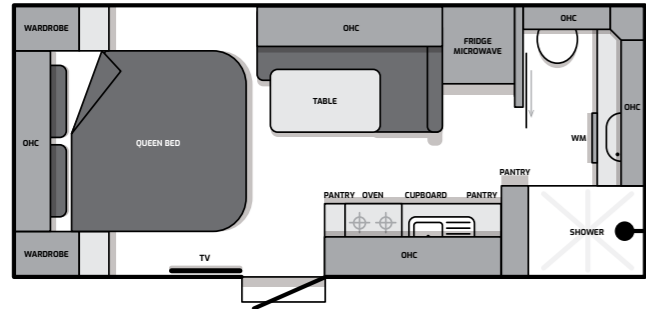

Rear Door (RD)

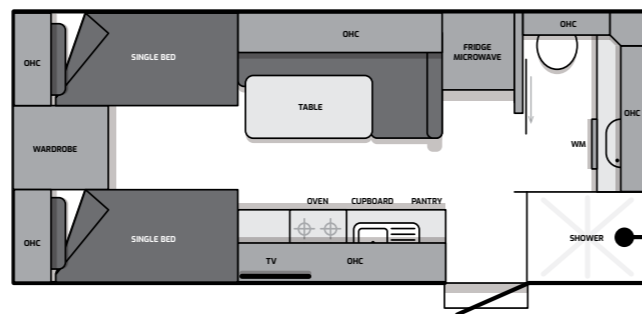
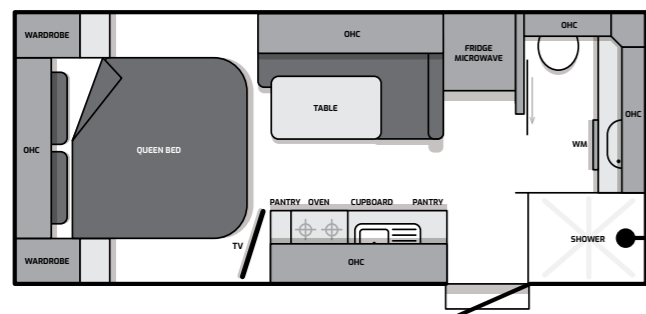

Toura 18ft 8

Centre Door (CD)

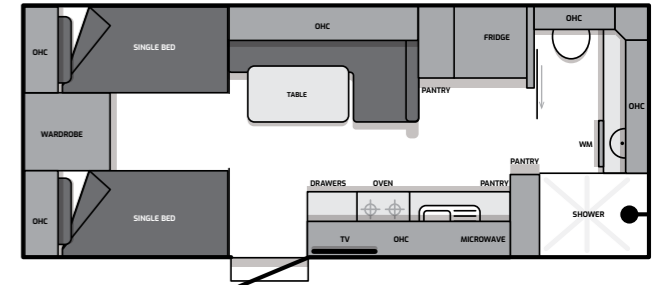
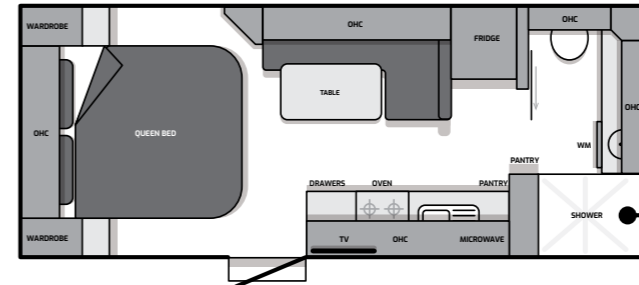
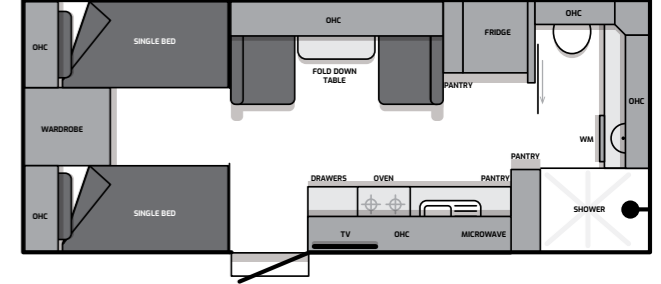
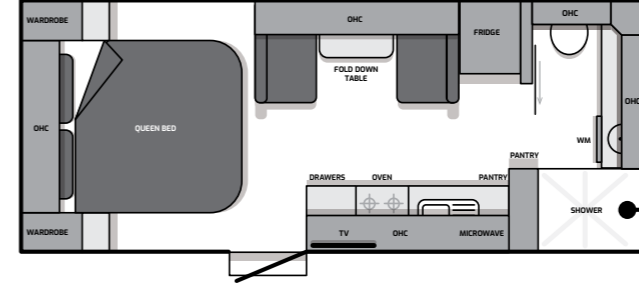

Rear Door (RD)

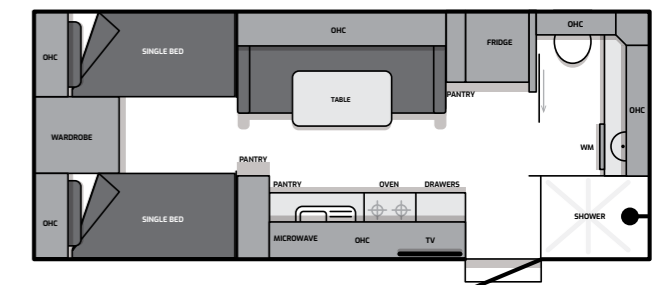
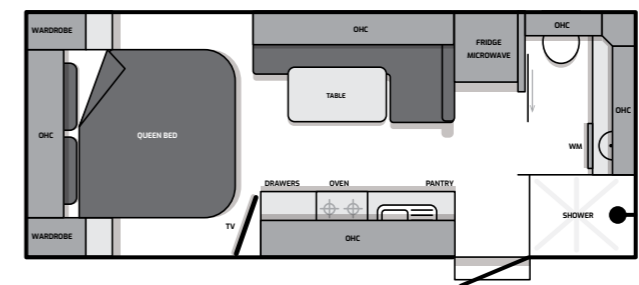
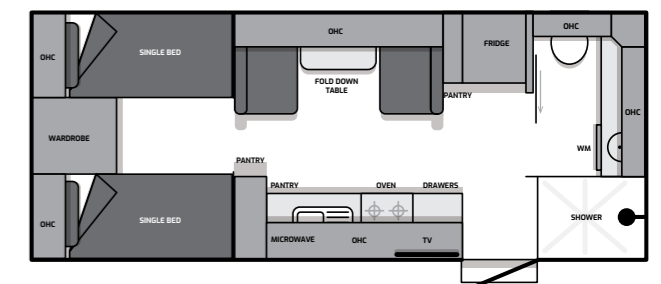
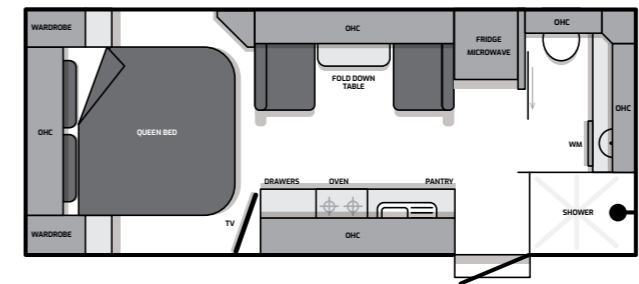

Toura 19ft 6

Centre Door (CD)

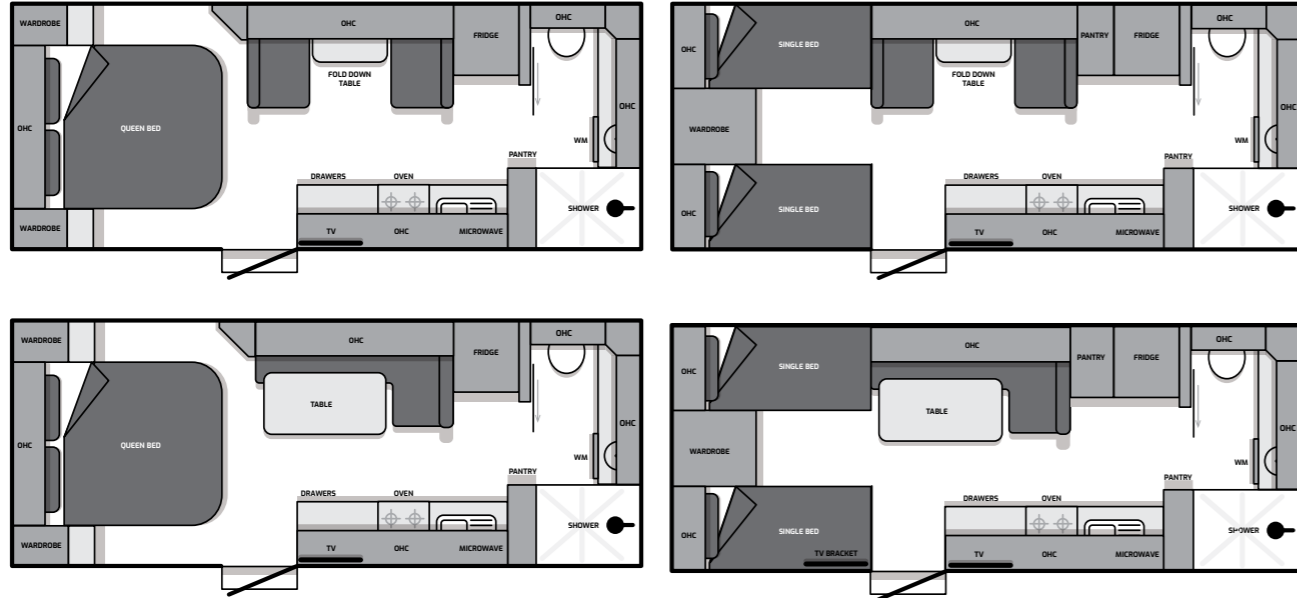

Rear Door (RD)

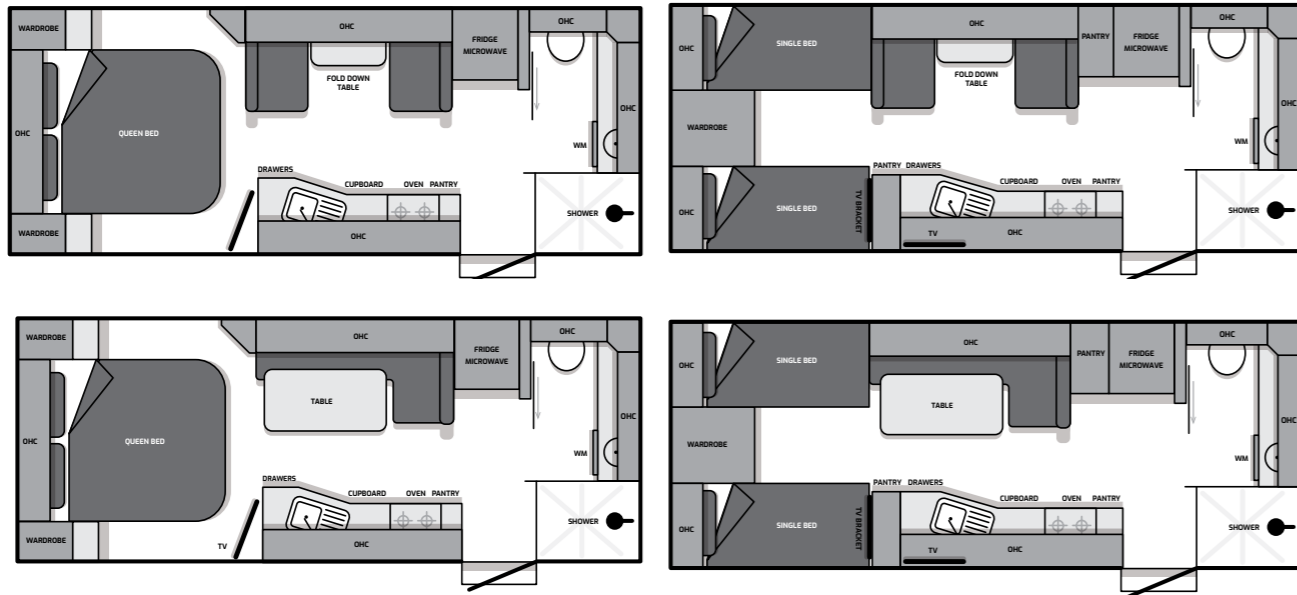

Toura 21ft 6

Rear Door (RD)

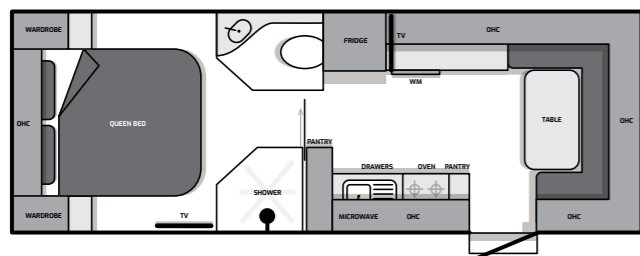

Toura 20ft 6

Centre Door (CD)

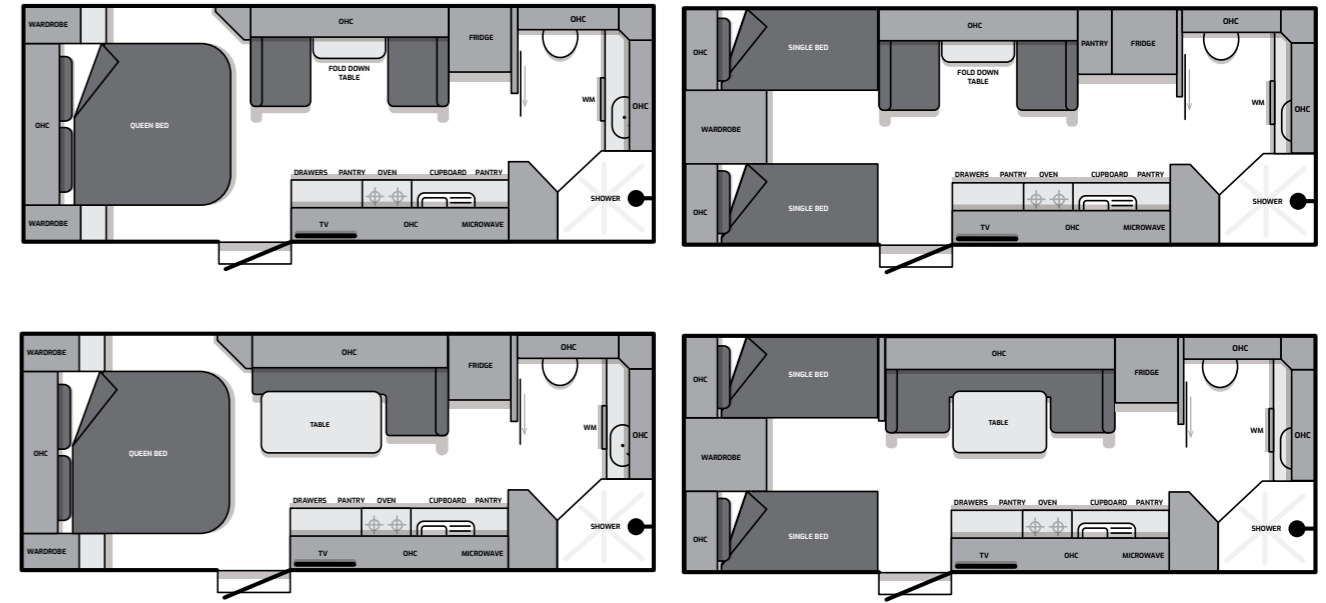

Rear Door (RD)

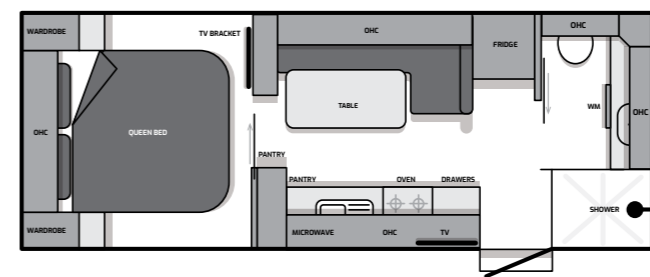

Toura 22ft 2

Centre Door (CD)

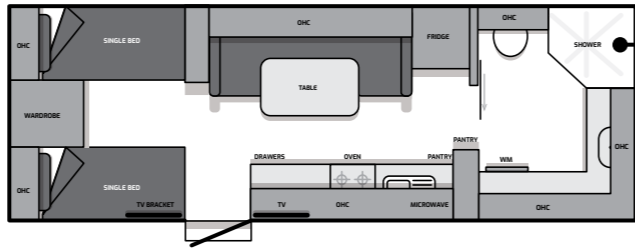
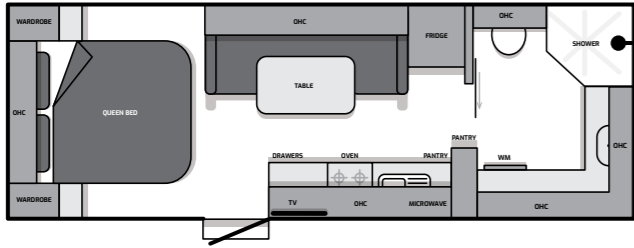
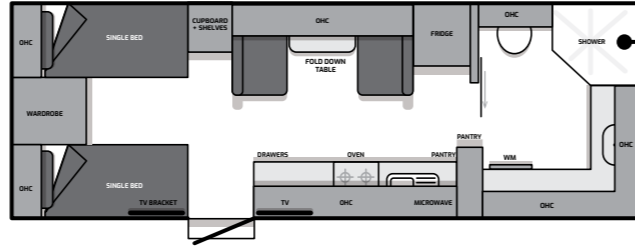
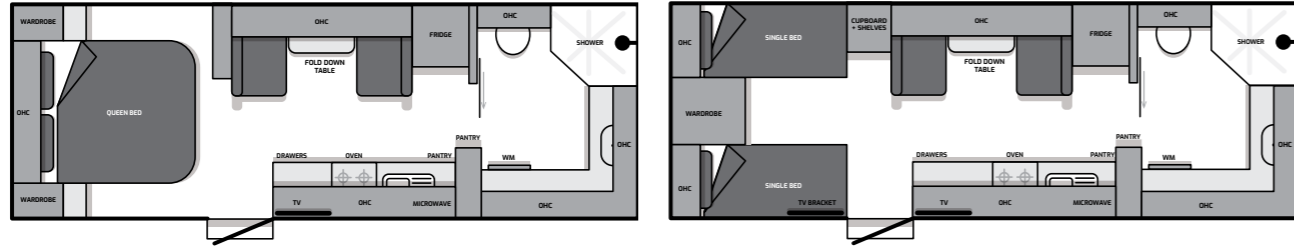

Rear Door (RD)

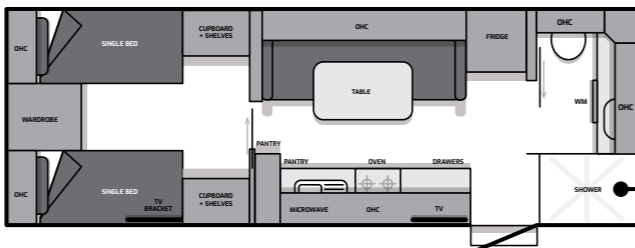
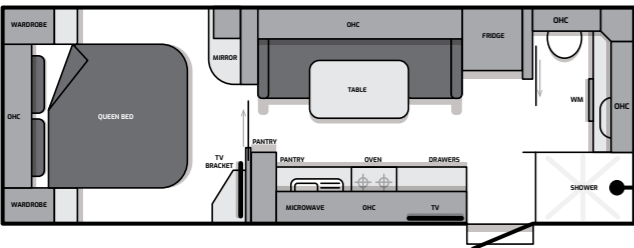
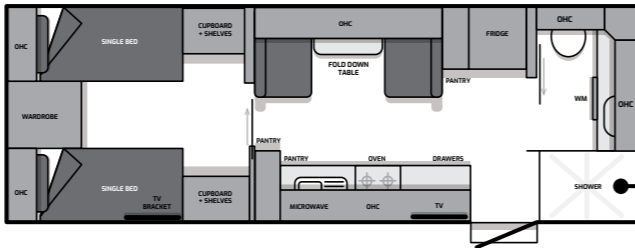
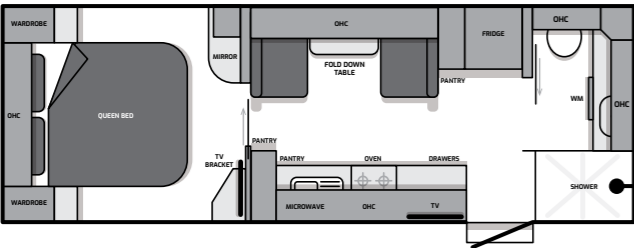

Toura 22ft 6

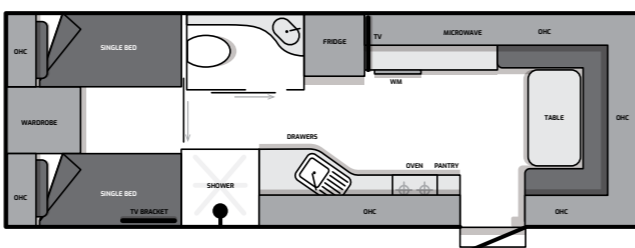
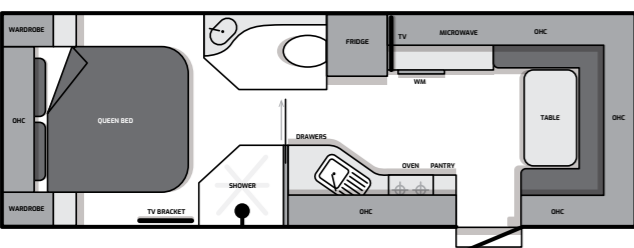

Toura Family 20ft 6

Centre Door (CD)

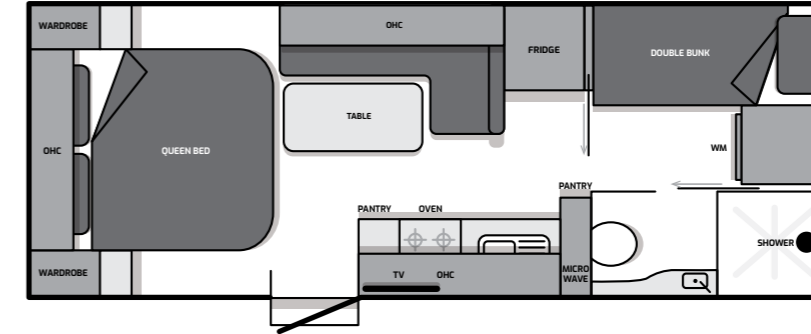

Toura Family 22ft 2

Centre Door (CD)

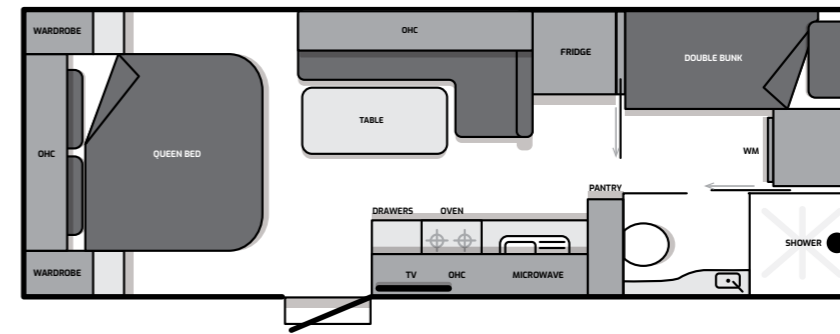

Toura Pop Top

16ft 9

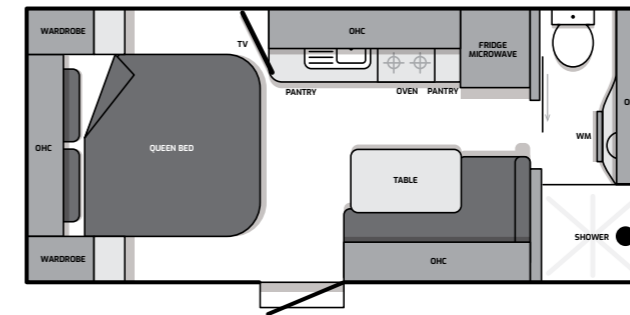

17ft 6 CD

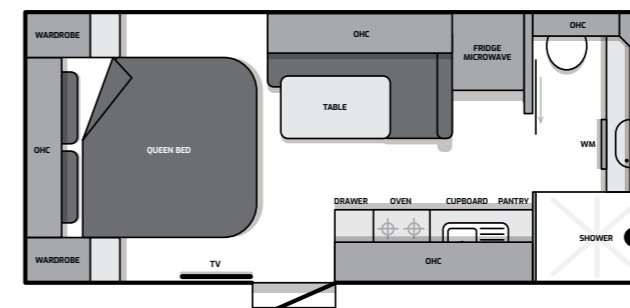

17ft 6 RD

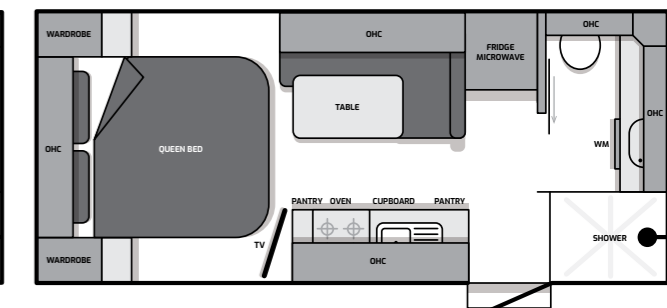

Specifications

Toura	16ft9"	17ft6"	18ft8"	19ft6"	20ft6"	21ft6"	22ft2"	22ft6"
Door Position	CD or RD	CD or RD	CD or RD	CD or RD	CD or RD	RD	CD or RD	RD
Standard Seating	L-Lounge	L-Lounge	Dinette	Dinette	Dinette	Rear Club	Side Club	Rear Club
Seating Options	NA	NA	L-Lounge	L-Lounge	L-Lounge	NA	Dinette	NA
Bed Options CD	NA	Single	Single	Single	Single	NA	Single	NA
Bed Options RD	Single	Single	Single	Single	Single	NA	Single	NA

Nominal Dimensions (mm)								
External length	5310	5510	5860	6110	6410	6710	6910	7020
Internal Length	5150	5350	5700	5950	6250	6550	6750	6860
Total Length includes A Frame & Spare Wheel	7555	7755	8105	8355	8655	8955	9155	9265
External width (including Rollup Awning)	2500	2500	2500	2500	2500	2500	2500	2500
Internal width	2285	2285	2285	2285	2285	2285	2285	2285
Internal Height	2010	2010	2010	2010	2010	2010	2010	2010
Total Travel Height with AC (Indicative)	3040	3040	2975	2975	2975	2995	2975	2975

Weights (kgs)								
Average Tare Weight	v	2375	2700	2760	2800	2820	2900	2900
Average Ball Weight	220	220	245	245	250	260	260	280
ATM (kgs)	2800	2800	3500	3500	3500	3500	3500	3500
Carry Load or Payload (Approximate)	500	425	800	740	700	680	600	600

Indicative weights, subject to change as dependent on the specification and options - See note 2

Indicative Height, subject to the wheel size, layout and load on the van axles/suspension.

Construction	16ft9"	17ft6"	18ft8"	19ft6"	20ft6"	21ft6"	22ft2"	22ft6"
Hot Dip Galvanised Chassis	•	•	•	•	•	•	•	•
Aluminium Wall Frame	•	•	•	•	•	•	•	•
Full Piece Composite Roof	•	•	•	•	•	•	•	•
Insulation to Walls and Ceilings	•	•	•	•	•	•	•	•
HoneyComb Flooring	•	•	•	•	•	•	•	•
Aluminium Composite Panel	•	•	•	•	•	•	•	•
Extended Draw Bar	•	•	•	•	•	•	•	•
Galvanised Rear Bumper with Spare Wheel	•	•	•	•	•	•	•	•
Sheeting in Tunnel Boot with Drainage at each side	•	•	•	•	•	•	•	•
Wheel Axle	Single	Single	Tandem	Tandem	Tandem	Tandem	Tandem	Tandem
XT Cruise Master 2.8T - Standard Arm	•	•						
CR52 Cruise Master 3.5T			•	•	•	•	•	•

Exterior								
15 inch wheels - Black with Inserts	NA	NA	•	•	•	•	•	•
16inch wheels - Black with Inserts	•	•	o	o	o	o	o	o
Checker Plate - Black, approx 550mm on sides and back	•	•	•	•	•	•	•	•
Aluminium Composite Panel - White	•	•	•	•	•	•	•	•
Aluminium Composite Panel - Silver, Charcoal or Dark Grey	o	o	o	o	o	o	o	o
Vinyl Decals Colours: Gold, Red, Blue, Silver, Charcoal	o	o	o	o	o	o	o	o
2 x 95litre water Tanks	•	•	•	•	•	•	•	•
Dual Water Tank Inlets	•	•	•	•	•	•	•	•
Grey Water Tank (110 Litres)	•	•	•	•	•	•	•	•

Toura	16ft9"	17ft6"	18ft8"	19ft6"	20ft6"	21ft6"	22ft2"	22ft6"
Hot Water System - Tank (Gas and Electric Heating)	•	•	•	•	•	•	•	•
Foam Lagging around PVC drainage pipes	•	•	•	•	•	•	•	•
Picnic Table	•	•	•	•	•	•	•	•
Mains Tap to A Frame & Mains Pressure	•	•	•	•	•	•	•	•
2 x 9kg Gas Bottles	•	•	•	•	•	•	•	•
Two Solar Panels with Regulator (200watts each)	•	•	•	•	•	•	•	•
Additional Solar Panel (200watts)	o	o	o	o	o	o	o	o
External Awning with centre support Bracket	•	•	•	•	•	•	•	•
Annexe Lights : Door side x 3, Drivers Side x1	•	•	•	•	•	•	•	•
Front and Rear LED Bar Light	•	•	•	•	•	•	•	•
Gas Bayonet	•	•	•	•	•	•	•	•
External Speakers	•	•	•	•	•	•	•	•
External Power Point and TV Point	•	•	•	•	•	•	•	•
Entrance Door 1850mm	•	•	•	•	•	•	•	•
Tool Box with Slider	•	•	•	•	•	•	•	•
Reversing Camera	•	•	•	•	•	•	•	•
DO35 Coupling	•	•	•	•	•	•	•	•
External Shower	•	•	•	•	•	•	•	•
External TV Point + Arm+ Locker	•	•	•	•	•	•	•	•

Electrical								
Batteries - Lithium Deep Cycle 120AH x 2	•	•	•	•	•	•	•	•
BMPRO BP35HA-II Management System, 20amp Mini Booster	•	•	•	•	•	•	•	•
Odyssey Touch Screen, Link 103, Anderson Plug	•	•	•	•	•	•	•	•
2 dippers water level indicators	•	•	•	•	•	•	•	•
Smart TV	24"	24"	24"	27"	27"	27"	27"	27"
Downlights	•	•	•	•	•	•	•	•

Internals								
CNC Cabinetry	•	•	•	•	•	•	•	•
Bi- Fold Dining Table STD In Dinette	NA	NA	•	•	•	NA	o	NA
Telescopic Dining Table with Tic Cushion	•	•	o	o	o	•	•	•
Exclusive Upholstery designs and Fabrics	•	•	•	•	•	•	•	•
Full Size Bedhead and Map Holder	•	•	•	•	•	•	•	•
Pelmets (Std : bedroom windows + Above seating)	•	•	•	•	•	•	•	•
Air Conditioner	•	•	•	•	•	•	•	•
Dometic RUA6408X 2 Door ABSRP Fridge 3WAY 188L	•	•	•	•	NA	NA	NA	NA
Dometic RUA8408X 2 Door ABSRP Fridge 3WAY 224L	NA	NA	NA	NA	•	•	•	•
Dometic RUC 6408X 2 Door Compressor Fridge 188L	o	o	o	o	NA	NA	NA	NA
Dometic RUC 8408X 2 Door Compressor Fridge 224L	NA	NA	NA	NA	o	o	o	o
Dometic MC101 Full Oven 3 Burner + 1 Gas - Grill - Oven	•	•	•	•	•	•	•	•
Dometic MC102 Cooktop 3 Burner + 1 Gas - Grill	o	o	o	o	o	o	o	o
Microwave	•	•	•	•	•	•	•	•
Slimline RangeHood	•	•	•	•	•	•	•	•
Qflow Exclusive Front Loader Washing Machine	•	•	•	•	•	•	•	•
Winegard HD Antenna	•	•	•	•	•	•	•	•

Specifications

Toura	16ft9"	17ft6"	18ft8"	19ft6"	20ft6"	21ft6"	22ft2"	22ft6"
Additional LED TV	o	o	o	o	o	o	o	o
Sirocco Fans	o	o	o	o	o	o	o	o
Skylight Hatch with LED lighting (450x400mm)	•	•	NA	NA	NA	NA	NA	NA
Skylight Hatch with LED lighting (700x500mm)	NA	NA	•	•	•	•	x1	x2
Sliding Door at Ensuite	•	•	•	•	•	NA	•	NA
2 Bathroom Exhaust Hatches with LED	•	•	•	•	•	•	•	•
InLine Dinking water filter	•	•	•	•	•	•	•	•
Aufocus Diesel Heater	•	•	•	•	•	•	•	•
Safety								
Breakaway Safety System	•	•	•	•	•	•	•	•
Fire Extinguisher	•	•	•	•	•	•	•	•
Smoke Alarm	•	•	•	•	•	•	•	•
Door - External 4 Pin lock with Security Screen	•	•	•	•	•	•	•	•
AL-KO ESC (Electronic Stability Control)	NA	NA	•	•	•	•	•	•
Dexter Stability Control	•	•	o	o	o	o	o	o
Fabric/Splash Board, Vanity, Kitchen Bench								
Number of Colour Combinations	7	7	7	7	7	7	7	7

Note 1:
The tow ball and tare weights are only a guide and will change depending on accessories that are fitted to your van. It is advisable to discuss this with your Millard Dealer covering your specific requirements.

Note 2:
Options are layout dependent and some options are not available on certain vans and should be discussed with your dealer

Note 3:
Product substitution may occur at times due to supply shortages, product discontinuation, product recall or other unforeseen reasons. Millard will inform the Dealer of the change which does not constitute a reason for order cancellation nor delaying the completion of the Caravan.

Key
 • Standard
 o Optional
 - Not Available

Optional Extras

Black Pack Option (Inclusions Noted)	
Matte Black Kitchen Sink	
Matte Black Round Basin	
Matte Black Shower Rail and Head	
Matte Black Double Towel Rack	
Matte Black Toilet Roll Holder	
Black Handles	
Internal Options	
Additional Bunk	
Single Beds Configuration	
Telescopic Dining Table with Tic Cushion	
Plumbing	
Webeasto AT2000 Diesel Heater with 12 litre Tank	
Truma Vario Gas Heater	
Dometic Slide Out Kitchen	
Eberspacher Airtronic D2 Diesel Heater	
Truma AquaGo HWS	
Truma Combi D6 Diesel Heater WMK Black	
Swift 801YR Swivel Slide Out BBQ	
Dometic RUC 8408X 2 Door (Compressor Fridge 224L)	
Dometic Fridge RUC6408x (Compressor 188 Litres)	
Gas Bottles inside Toura Toolbox	
Bundle Option	
K-RV80-03 200BT-Bundle 200Ah BTECH Battery	
Enerdrive Inverter 2000W	
Enerdrive Inverter 2600W	
Note : Inverters require Shunt with BM Pro Management system	
Battery Option	
Remove Lithium Battery and Revert 100 AGM Battery	
Additional 100AGM Battery	
Additional 125 Ah Lithium Battery	

External Options	
Bike Rack	
Stone Guard Protector	
Jerry Can Holders	
Pressure Hatch / Scupper Vent	
Mesh on the A- Frame	
Dometic Dust Hatch	
Carafan CP700 Pressuriser	
Wheel Upgrade to 16"	
Front Window with Cover	
893x228mm Access Hatch (under 1st Bunk Bed for Double Bunks only)	
Underslung Wheel Carrier (excludes rear club vans)	
Additional Spare wheel + Bracket +T bar for No. Plate	
Double or Single Electric Step	
Manual Double Step	
Heavy Duty Bumper 3 arms	
Electrical	
Additional Solar Panel 200watts	
12V Sirocco Fans (White or Black)	
Additional 12V Power Point Outlet	
Additional External Power Point	
Additional Internal Double Power Point	
Extra Annexe Light	
Additional Internal TV Point +TV+Bracket	
Sphere Satellite System : Only to be fitted to vans 18ft8 or greater	
Additional Internal TV Point	
Coaxial Cable Connection (12v point+TV Point+240V powerpoint)	
Safety Options	
BM Pro Sway Control	
Dexter Sway Control	
Suspension Options (POA)	
Single Axle : Cruisemaster 3T ATX	
Dual Axle : Cruisemaster XT or ATX	

Specifications — Family Vans

Toura Family Vans	20ft6"	22ft2"
Door Position	CD	CD
Standard Seating	L- Lounge	L- Lounge
Bedding	Double Bunks	Double Bunks
Bedding Option	Triple Bunks	Triple Bunks

Nominal Dimensions (mm)		
External length	6410	6910
Internal Length	6250	6750
Total Length includes A Frame & Spare Wheel	8655	9155
External width (including Rollup Awning)	2500	2500
Internal width	2285	2285
Internal Height	2010	2010
Total Travel Height with AC (Indicative)	2975	2975

Weights (kgs)		
Average Tare Weight	2800	2900
Average Ball Weight	250	260
ATM (kgs)	3500	3500
Carry Load or Payload (Approximate)	700	600

Indicative weights, subject to change as dependent on the specification and options - See note 2

Indicative Height, subject to the wheel size, layout and load on the van axles/suspension.

Construction	20ft2"	22ft2"
Hot Dip Galvanised Chassis	•	•
Aluminium Wall Frame	•	•
Full Piece Composite Roof	•	•
Insulation to Walls and Ceilings	•	•
HoneyComb Flooring	•	•
Aluminium Composite Panel	•	•
Extended Draw Bar	•	•
Galvanised Rear Bumper with Spare Wheel	•	•
Sheeting in Tunnel Boot with Drainage at each side	•	•
Wheel Axle	Tandem	Tandem
CR52 Cruise Master 3.5T	•	•

Exterior		
15 inch wheels - Black with Inserts	•	•
16inch wheels - Black with Inserts	o	o
Checker Plate - Black, approx 550mm on sides and back	•	•
Aluminium Composite Panel - White	•	•
Aluminium Composite Panel - Silver or Charcoal or Dark Grey	o	o
Vinyl Decals Colours: Gold, Red, Blue, Silver, Charcoal	o	o
2 x 95litre water Tanks	•	•

Specifications — Family Vans

Toura Family Vans	20ft6"	22ft2"
Dual Water Tank Inlets	•	•
Grey Water Tank (110 Litres)	•	•
Hot Water System - Tank (Gas and Electric Heating)	•	•
Foam Lagging around PVC drainage pipes	•	•
Picnic Table	•	•
Mains Tap to A Frame & Mains Pressure	•	•
2 x 9kg Gas Bottles	•	•
Two Solar Panels with Regulator (200watts each)	•	•
Additional Solar Panel (200watts)	o	o
External Awning with centre support Bracket	•	•
Annexe Lights : Door side x 3, Drivers Side x1	•	•
Front and Rear LED Bar Light	•	•
Gas Bayonet	•	•
External Speakers	•	•
External Power Point and TV Point	•	•
Entrance Door 1850mm	•	•
Tool Box with Slider	•	•
Reversing Camera	•	•
D035 Coupling	•	•
External Shower	•	•
External TV Point + Arm+ Locker	•	•

Electrical		
Batteries - Lithium Deep Cycle 120AH x 2	•	•
BMPRO BP35HA-II Management System, 20amp Mini Booster	•	•
Odyssey Touch Screen, Link 103, Anderson Plug	•	•
2 dippers water level indicators	•	•
Smart TV	27"	27"
Downlights	•	•

Internals		
CNC Cabinetry	•	•
Telescopic Dining Table with Tic Cushion	•	•
Exclusive Upholstery designs and Fabrics	•	•
Full Size Bedhead and Map Holder	•	•
Pelmets (Std : bedroom windows + Above seating)	•	•
Air Conditioner	•	•
Dometic RUA8408X 2 Door ABSRP Fridge 3WAY 224L	•	•
Dometic RUC 8408X 2 Door Compressor Fridge 224L	o	o
Dometic MC101 Full Oven 3 Burner + 1 Gas - Grill - Oven	•	•
Dometic MC102 Cooktop 3 Burner + 1 Gas - Grill	o	o
Microwave	•	•

Key
 • Standard
 o Optional
 - Not Available

Specifications – Family Vans

Toura Family Vans	20ft6"	22ft2"
Slimline RangeHood	•	•
Qflow Exclusive Front Loader Washing Machine	•	•
Winegard HD Antenna	•	•
Additional 27" LED TV	o	o
Sirocco Fans	o	o
Skylight Hatch with LED lighting (700x500mm)	•	•
Two Sliding Door at Ensuite and Bunk Entrance	•	•
2 Bathroom Exhaust Hatches with LED	•	•
InLine Dinking water filter	•	•
Aufocus Diesel Heater	•	•
Safety		
Breakaway Safety System	•	•
Fire Extinguisher	•	•
Smoke Alarm	•	•
Door - External 4 Pin lock with Security Screen	•	•
AL-KO ESC (Electronic Stability Control)	•	•
Fabric/Splash Board, Vanity, Kitchen Bench		
Number of Colour Combinations	7	7
L- Lounge with one end foot rest and Tic Cushion		
•	•	•
Family Bunk Van		
Additional Bunk	o	o
External Access Hatch 893x228mm (under 1st Bunk Bed for Double Bunks only)	o	o

Note 1:
The tow ball and tare weights are only a guide and will change depending on accessories that are fitted to your van. It is advisable to discuss this with your Millard Dealer covering your specific requirements.

Note 2:
Options are layout dependent and some options are not available on certain vans and should be discussed with your dealer

Note 3:
Product substitution may occur at times due to supply shortages, product discontinuation, product recall or other unforeseen reasons. Millard will inform the Dealer of the change which does not constitute a reason for order cancellation nor delaying the completion of the Caravan.

Key
• Standard
o Optional
- Not Available

Specifications – Pop Top

Toura Pop Top	16ft9"	17ft6"
Door Position	CD	CD Or RD
Standard Seating	L-Lounge	L-Lounge
Nominal Dimensions (mm)		
External length	5310	5510
Internal Length	5150	5350
Total Length includes A Frame & Spare Wheel	7555	7755
External width (including Rollup Awning)	2500	2500
Internal width	2285	2285
Internal Height (roof closed)	1690	1690
Internal Height (roof open)	1990	1990
Total External Height (includes Hatch + Winegard Antenna) - Open	2850	2850
Total External Height (includes Hatch + Winegard Antenna) - Closed	2560	2560
Weights (kgs)		
Average Tare Weight	2225	2280
ATM (kgs)	2800	2800
Carry Load or Payload (Approximate)	575	520
Average Ball Weight	220	220
Indicative weights, subject to change as dependent on the specification and options - See note 2		
Indicative Height, subject to the wheel size, layout and load on the van axles/suspension.		
Construction		
Hot Dip Galvanised Chassis	•	•
Aluminium Wall Frame	•	•
Full Piece Composite Roof	•	•
Insulation to Walls and Ceilings	•	•
HoneyComb Flooring	•	•
Aluminium Composite Panel	•	•
Extended Draw Bar	•	•
Galvanised Rear Bumper with Spare Wheel	•	•
Sheeting in Tunnel Boot with Drainage at each side	•	•
Wheel Axle	Tandem	Tandem
XT Cruise Master 2.8T - Standard Arm	•	•
XT Cruise Master 2.8T - Drop Arm (60mm height reduction)	o	o
Exterior		
16inch wheels - Black with Inserts	•	•
Checker Plate - Black, approx 550mm on sides and back	•	•
Aluminium Composite Panel - White	•	•
Aluminium Composite Panel - Silver or Charcoal or Dark Grey	o	o
Vinyl Decals Colours: Gold, Red, Blue, Silver,Charcoal	o	o
2 x 95litre water Tanks	•	•
Dual Water Tank Inlets	•	•
Grey Water Tank (110 Litres)	•	•

Key
• Standard
o Optional
- Not Available

Specifications – Pop Top

Toura Pop Top	16ft9"	17ft6"
Hot Water System - Tank (Gas and Electric Heating)	•	•
Foam Lagging around PVC drainage pipes	•	•
Picnic Table	•	•
Mains Tap to A Frame & Mains Pressure	•	•
2 x 9kg Gas Bottles	•	•
Two Solar Panels with Regulator (200watts each)	•	•
Additional Solar Panel (200watts)	o	o
External Awning with centre support Bracket	•	•
Annexe Lights : Door side x 3, Drivers Side x1	•	•
Front and Rear LED Bar Light	•	•
Gas Bayonet	•	•
External Speakers	•	•
External Power Point and TV Point	•	•
Entrance Door 1850mm	•	•
Tool Box with Slider	•	•
Reversing Camera	•	•
D035 Coupling	•	•
External Shower	•	•
External TV Point + Arm+ Locker	•	•
Electrical		
Batteries - Lithium Deep Cycle 120AH x 2	•	•
BMPRO BP35HA-II Management System, 20amp Mini Booster	•	•
Odyssey Touch Screen, Link 103, Anderson Plug	•	•
2 dippers water level indicators	•	•
Smart TV	24"	24"
Downlights	•	•
Internals		
CNC Cabinetry	•	•
Tri Fold Dining Table	NA	NA
Telescopic Dining Table with Tic Cushion	•	•
Exclusive Upholstery designs and Fabrics	•	•
Full Size Bedhead and Map Holder	•	•
Pelmets (Std : bedroom windows + Above seating)	•	•
Truma Saphir RC (located under the mattress)	•	•
Dometic RMD10.5XS(3 Way Absorption Fridge - 175L Net)	•	•
Dometic MC101 Full Oven 3 Burner + 1 Gas - Grill - Oven (See Note 3)	o	o
Dometic MC102 Cooktop 3 Burner + 1 Gas - Grill	•	•
Microwave	•	•

Specifications – Pop Top

Toura Pop Top	16ft9"	17ft6"
Slimline RangeHood	•	•
Qflow Exclusive Front Loader Washing Machine	•	•
Winegard HD Antenna	•	•
Additional 24" LED TV	o	o
Sirocco Fans	o	o
Skylight Hatch with LED lighting (450x400mm)	•	•
Skylight Hatch with LED lighting (700x500mm)	NA	NA
2 Bathroom Exhaust Hatches with LED	•	•
Sliding door at Ensuite	•	•
InLine Dinking water filter	•	•
Aufocus Diesel Heater	•	•
Safety		
Breakaway Safety System	•	•
Fire Extinguisher	•	•
Smoke Alarm	•	•
Door - External 4 Pin lock with Security Screen	•	•
Dexter Stability Control	•	•
Fabric/Splash Board, Vanity, Kitchen Bench		
Number of Colour Combinations	7	7
Dining/Seating Configuration		
L- Lounge with one end foot rest and Tic Cushion	•	•

Note 1:
The tow ball and tare weights are only a guide and will change depending on accessories that are fitted to your van. It is advisable to discuss this with your Millard Dealer covering your specific requirements.

Note 2:
Options are layout dependent and some options are not available on certain vans and should be discussed with your dealer

Note 3:
If full oven is selected, the cooktop lid is the glass lid supplied with the oven. That is, there is no additional laminex lid as the oven cannot be recessed below the benchtop height.

Note 4:
Product substitution may occur at times due to supply shortages, product discontinuation, product recall or other unforeseen reasons. Millard will inform the Dealer of the change which does not constitute a reason for order cancellation nor delaying the completion of the Caravan.

MILLARD

CARAVANS

Unit 1/36-42 Orange Grove Road,
Warwick Farm NSW 2170

02 9829 2055

info@millardrv.com.au

Your ticket to *freedom* since 1947

Your Millard Caravans Dealer:

