



Your ticket to *freedom* since 1947



The Trusted name
for 78 years

BREAKAWAY

Couples Van Layouts

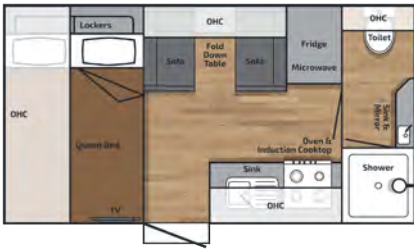

BR147CDQBEWDS

External Body Length: 4480mm Overall Height: 3200mm
Overall External Length: 7180mm Overall Width: 2500mm
End Coupling to Outer Spare Tyre

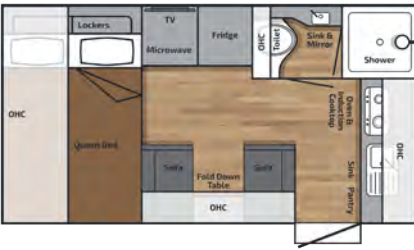

BR149RDQBEWDS

External Body Length: 4530mm Overall Height: 3200mm
Overall External Length: 6930mm Overall Width: 2500mm
End Coupling to Outer Spare Tyre

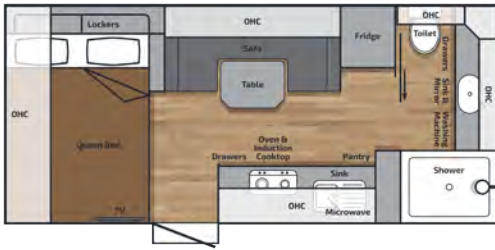

BR176CDQBEWSC

External Body Length: 5365mm Overall Height: 3200mm
Overall External Length: 8065mm Overall Width: 2500mm
End Coupling to Outer Spare Tyre

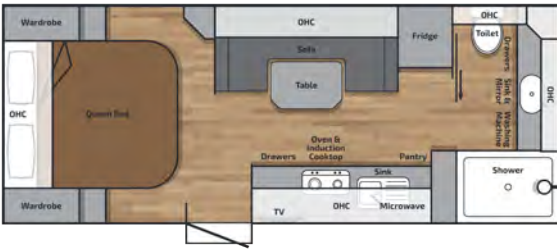

BR199CDQBSC

External Body Length: 6055mm Overall Height: 3200mm
Overall External Length: 8755mm Overall Width: 2500mm
End Coupling to Outer Spare Tyre

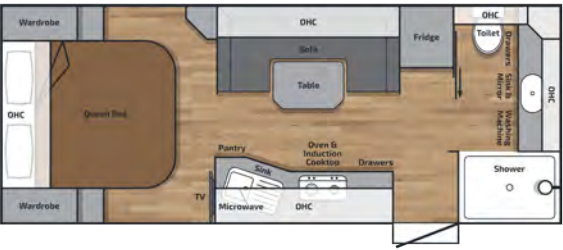

BR1911RDQBSC

External Body Length: 6105mm Overall Height: 3200mm
Overall External Length: 8505mm Overall Width: 2500mm
End Coupling to Outer Spare Tyre

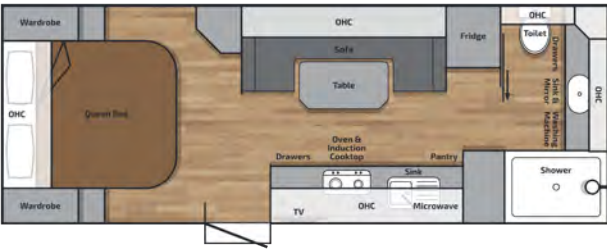

BR216CDQBSC

External Body Length: 6590mm Overall Height: 3200mm
Overall External Length: 9290mm Overall Width: 2500mm
End Coupling to Outer Spare Tyre

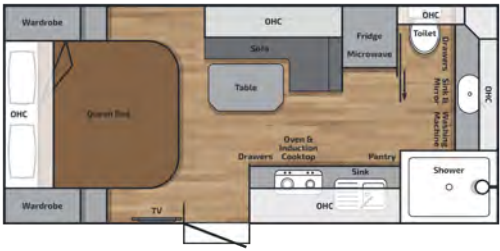

BR176CDQBLL

External Body Length: 5365mm Overall Height: 3200mm
Overall External Length: 8065mm Overall Width: 2500mm
End Coupling to Outer Spare Tyre

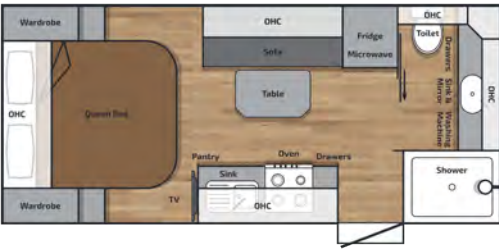

BR178RDQBDS

External Body Length: 5420mm Overall Height: 3200mm
Overall External Length: 7820mm Overall Width: 2500mm
End Coupling to Outer Spare Tyre

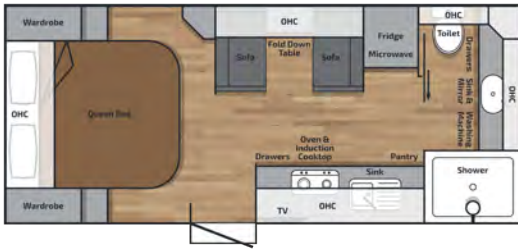

BR183CDQBDS

External Body Length: 5595mm Overall Height: 3200mm
Overall External Length: 8295mm Overall Width: 2500mm
End Coupling to Outer Spare Tyre

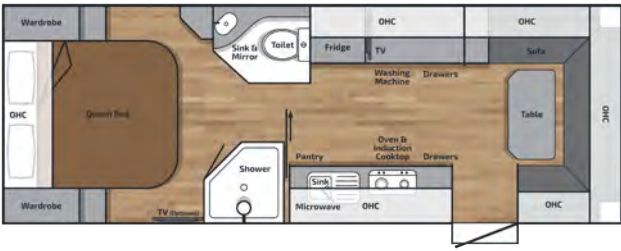

BR2111RDQBRC

External Body Length: 6715mm Overall Height: 3200mm
Overall External Length: 9425mm Overall Width: 2500mm
End Coupling to Outer Spare Tyre

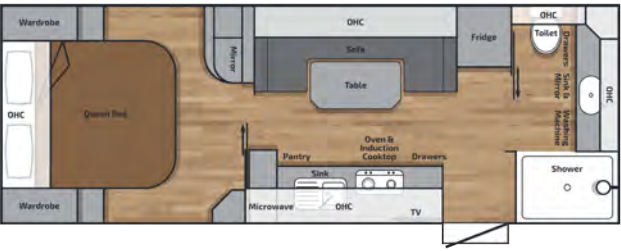

BR2111RDQBSC

External Body Length: 6715mm Overall Height: 3200mm
Overall External Length: 9425mm Overall Width: 2500mm
End Coupling to Outer Spare Tyre

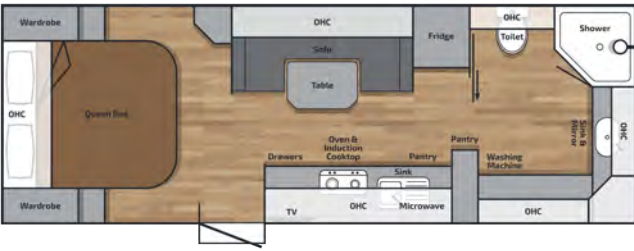

BR226CDQBSC

External Body Length: 6895mm Overall Height: 3200mm
Overall External Length: 9605mm Overall Width: 2500mm
End Coupling to Outer Spare Tyre

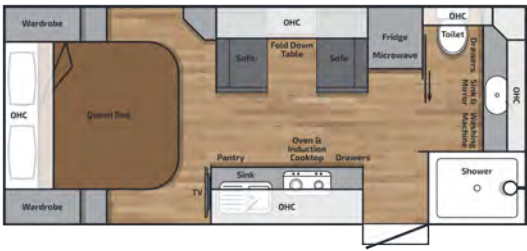

BR185RDQBDS

External Body Length: 5645mm Overall Height: 3200mm
Overall External Length: 8035mm Overall Width: 2500mm
End Coupling to Outer Spare Tyre

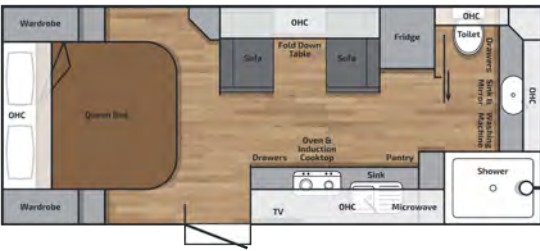

BR192CDQBDS

External Body Length: 5875mm Overall Height: 3200mm
Overall External Length: 8575mm Overall Width: 2500mm
End Coupling to Outer Spare Tyre

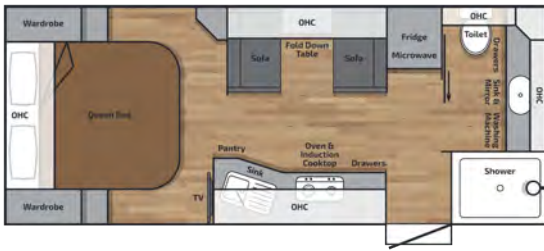

BR194RDQBDS

External Body Length: 5925mm Overall Height: 3200mm
Overall External Length: 8325mm Overall Width: 2500mm
End Coupling to Outer Spare Tyre

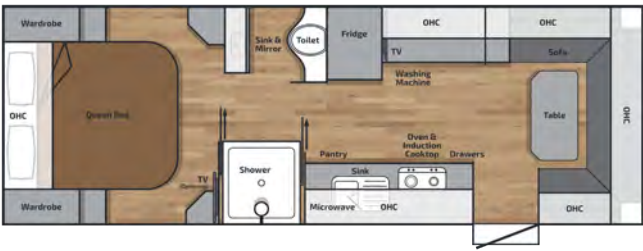

BR228RDQBRC

External Body Length: 6945mm Overall Height: 3200mm
Overall External Length: 9645mm Overall Width: 2500mm
End Coupling to Outer Spare Tyre

Specifications

Model	14ft7 (CD) / 14ft9 (RD)	17ft6EW (CD) / 17ft6 (CD) / 17ft8 (RD)	18ft3 (CD) / 18ft5 (RD)	19ft2 (CD) / 19ft4 (RD)	19ft9 (CD) / 19ft11 (RD)	21ft6 (CD)	21ft11 (RD)	21ft11 (RD)	22ft6 (CD)	22ft8 (RD)
Door Position Reference	CD/ RD	CD / RD	CD / RD	CD / RD	CD / RD	CD	RD	RD	CD	RD
Seating Arrangement - Centre Door	Dinette	Side Club EW /L- Lounge	Dinette	Dinette	Side Club	Side Club			Side Club	NA
Seating Arrangement - Rear Door	Dinette	Dinette	Dinette	Dinette	side Club	NA	Rear Club	Side Club	NA	Rear Club
Other Seating Options	L-Lounge	L-Lounge RD Only	L-Lounge	L-Lounge	Dinette or L- Lounge	Dinette	Side Club or Dinette	Dinette	Dinette	NA
Captian Chairs	NA	17ft6 EW CD	Optional CD&RD	Optional CD&RD	NA	NA	Optional in Rear Club	NA	NA	Optional in Rear Club
Single Beds (seating change to Side Club)	NA	NA	Optional	Optional	Optional RD Only	NA	Optional in Rear Club	NA	NA	Optional in Rear Club
Dimensions										
External Body Length	4480mm (CD) / 4530mm (RD)	5365mm (CD) / 5420mm (RD)	5595mm (CD) / 5645mm (RD)	5875mm (CD) / 5925mm (RD)	6055mm (CD) / 6105mm (RD)	6590mm (CD)	6715mm (RD)	6715mm (RD)	6895mm (CD)	6945mm (RD)
External Length (End Coupling to Outer Spare Tyre)	7180mm(CD)	8065mm(CD)	8295mm(CD)	8575mm(CD)	8755mm(CD)	9290mm(CD)	9425mm(RD)	9425mm(RD)	9605mm(CD)	9645mm(RD)
External Length (End Coupling to Outer Bumper Bar : Underslung spare wheel)	6930mm(RD)	7820mm(RD)	8035mm(RD)	8325mm(RD)	8505mm(RD)					
External Height (Ground to Top of AC Unit) - Variable	3200mm	3200mm	3200mm	3200mm	3200mm	3200mm	3200mm	3200mm	3200mm	3200mm
External Width includes all protruding fixtures	2500mm	2500mm	2500mm	2500mm	2500mm	2500mm	2500mm	2500mm	2500mm	2500mm
Internal Length	4335mm (CD) / 4385mm (RD)	5225mm(CD) / 5275mm (RD)	5475mm(CD) / 5525mm (RD)		5900mm (CD) / 5950mm (RD)	6425mm (CD)	6550mm (RD)	6550mm (RD)	6725mm (CD)	6825mm (RD)
Internal Height	2010mm	2010mm	2010mm	2010mm	2010mm	2010mm	2010mm	2010mm	2010mm	2010mm
Internal Width	2285mm	2285mm	2285mm	2285mm	2285mm	2285mm	2285mm	2285mm	2285mm	2285mm
ATM	3000kgs	3000kgs	3000kgs	3500kgs	4500kgs	4500kgs	4500kgs	4500kgs	4500kgs	4500kgs
Note : Indicative lengths are standard configuration, any additional options or variations could change these figures										
Construction										
Alko Engineered Designed Infill Flat Floor (TRUSS) - Galvanized	•	•	•	•	•	•	•		•	•
Options : SuperGal Painted Charcoal or Enduro Paint	o	o	o	o	o	o	o	o	o	o
Alko Chassis Construction:										
Extended Aframe (steel 6" x 2") C450	1800mm	1800mm	1800mm	1800mm	1800mm	1800mm	1800mm	1800mm	1800mm	1800mm
Truss Main Bearers Top: 75x50 Grade C350	•	•	•	•	•	•	•	•	•	•
Truss Main Bearers Bottom: 50x50x3mm Grade C350	•	•	•	•	•	•	•	•	•	•

Model	14ft7 (CD) / 14ft9 (RD)	17ft6EW (CD) / 17ft6 (CD) / 17ft8 (RD)	18ft3 (CD) / 18ft5 (RD)	19ft2 (CD) / 19ft4 (RD)	19ft9 (CD) / 19ft11 (RD)	21ft6 (CD)	21ft11 (RD)	21ft11 (RD)	22ft6 (CD)	22ft8 (RD)
Construction										
Aluminium Wall Frame	•	•	•	•	•	•	•	•	•	•
Full Piece Composite Roof : 5 Colour Options	•	•	•	•	•	•	•	•	•	•
22mm XPS Moisture Resistant Insulation between Aluminium Wall Frames	•	•	•	•	•	•	•	•	•	•
PolyHoney Comb Heavy Duty Flooring 38mm plus Fibreglass skin	•	•	•	•	•	•	•	•	•	•
30mm One Piece XPS Insulated CNC Pre-Fabricated Roof	•	•	•	•	•	•	•	•	•	•
Aluminium Composite Panel : 5 Colour Options	•	•	•	•	•	•	•	•	•	•
Cruisemaster Single ATX 3.0T Airbag L3 Manual 12" inch Electric Brakes	•	•	•	NA	NA	NA	NA	NA	NA	NA
Cruisemaster Tandem ATX 4.5T Airbag L3 Manual 12"Electric Brakes	NA	NA	NA	•	•	•	•	•	•	•
DO35 Coupling	•	•	•	•	NA	NA	NA	NA	NA	NA
DO45 V2 HitchMaster Coupling with Heavy Duty Chains	NA	NA	NA	o	•	•	•	•	•	•
Exterior										
265/75 R17 Mud Tyres on Black Rims Includes One Spare Wheel	•	•	•	•	•	•	•	•	•	•
Black Checker Plate , approx 900mm on sides	•	•	•	•	•	•	•	•	•	•
Printed Decals Choice of 5 colours	•	•	•	•	•	•	•	•	•	•
Picnic Table	•	•	•	•	•	•	•	•	•	•
External TV Box	NA	•	•	•	•	•	•	•	•	•
External Awning with Mid roller support	NA	•	•	•	•	•	•	•	•	•
Electric Awning	•	o	o	o	o	o	o	o	o	o
Double Manual Entry Step	•	•	•	•	•	•	•	•	•	•
Entry Door Grab Handle with Light	•	•	•	•	•	•	•	•	•	•
Bumper Bar 4 arm 45 DEG 46" STD	•	•	•	•	•	•	•	•	•	•
Spare Wheel (x1) and Holder at Rear on Bumper Bar	14ft7 (CD)	17ft6 (CD)	18ft3 (CD)	19ft2 (CD)	19ft9 (CD)	•	•	•	•	•
Underslung Spare Wheel (at the Aframe)	14ft9 (RD)	17ft8 (RD)	18ft5 (RD)	19ft4 (RD)	19ft11 (RD)	o	o	o	o	o
Alko 8" Jockey Wheel	•	•	•	•	•	•	•	•	•	•
Full Width Tunnel Boot	•	•	•	•	•	•	•	•	•	•

Specifications

Model	14ft7 (CD) / 14ft9 (RD)	17ft6EW (CD) / 17ft6 (CD) / 17ft8 (RD)	18ft3 (CD) / 18ft5 (RD)	19ft2 (CD) / 19ft4 (RD)	19ft9 (CD) / 19ft11 (RD)	21ft6 (CD)	21ft11 (RD)	21ft11 (RD)	22ft6 (CD)	22ft8 (RD)
Exterior										
Checker Plate Toolbox with Double Sliders , Internally Mounted Gas Bottles	•	•	•	•	•	•	•	•	•	•
Carafan Sahara Dust Reduction System	•	•	•	•	•	•	•	•	•	•
Jerry Cans x 2	•	•	•	•	•	•	•	•	•	•
Fusion Panel Speaker Outdoor plus Mounting Bracket, with SRX400 Marine Stereo	•	•	•	•	•	•	•		•	•
Safety Dave RV 6" Dash Kit (Dual Camera with Double Woza Scren and Car Wiring)	NA	•	•	•	•	•	•		•	•
Wireless Reversing Camera	•	o	o	o	o	o	o	o	o	o
Electrical										
Enerdrive eSYS-ICA-SI-03 consisting of	•	•	•	•	•	•	•		•	•
3000W Inverter /Charger / 100A-12V Pure Sinewave Ouput	•	•	•	•	•	•	•		•	•
40Amp DC_DC Charger	•	•	•	•	•	•	•		•	•
40Amp Solar Charger x 2	•	•	•	•	•	•	•		•	•
Simarine VIA Digital Switch Control Panel	•	•	•	•	•	•	•		•	•
4 Water Tank Monitoring Sensors	•	•	•	•	•	•	•		•	•
2 x 300Ah B-TEC Enerdrive G2 Lithium Batteries	•	•	•	•	•	•	•	•	•	•
Number of Solar Panels - (200watts each/ model dependant)	X 2 Only	X3	X3	X4	X4	X4	X4	X4	X4	X4
Anderson Plug - DCtoDC Battery Charging	•	•	•	•	•	•	•	•	•	•
Additional Anderson Plug - Portable Solar Panel	•	•	•	•	•	•	•	•	•	•
Dexter Anti Sway System (DSC)	•	•	•	•	•	•	•	•	•	•
Carafan Sahara Dust Reduction System	•	•	•	•	•	•	•	•	•	•
Starlink Ready: 12V Starlink Cosmo (for Starlink Gen 3)	•	•	•	•	•	•	•	•	•	•
Fusion Radio Apollo 770 Stereo System Plus Fusion Corner Speakers (2 Bedroom and 2 Seating Area)	•	•	•	•	•	•	•	•	•	•
Soft LED strip Lights at : Main Bed Side Tables, Under the Kitchen OHC and Ensuite Cabinetry (Under OHC and KickBoard)	•	•	•	•	•	•	•	•	•	•

Model	14ft7 (CD) / 14ft9 (RD)	17ft6EW (CD) / 17ft6 (CD) / 17ft8 (RD)	18ft3 (CD) / 18ft5 (RD)	19ft2 (CD) / 19ft4 (RD)	19ft9 (CD) / 19ft11 (RD)	21ft6 (CD)	21ft11 (RD)	21ft11 (RD)	22ft6 (CD)	22ft8 (RD)
Electrical										
Multi Colour Annex Light - Door Side	x2	x2	x2	x3	x3	x3	x3	x3	x3	x3
Multi Colour Annex Light - Driver Side	x1	x1	x1	x1	x1	x1	x1	x1	x1	x1
External Power Point at Picnic Table	•	•	•	•	•	•	•	•	•	•
Reversing Camera	NA	•	•	•	•	•	•	•	•	•
Wireless Reversing Camera	•	o	o	o	o	o	o	o	o	o
24" Smart TV (Van size : 14ft7-18ft5)	•	•	•	NA	NA	NA	NA	NA	NA	NA
27" Smart TV (Van size > 19ft2)	NA	NA	NA	•	•	•	•	•	•	•
Tunnel Boot lighting at lockable doors , both sides	•	•	•	•	•	•	•	•	•	•
240V Single Power point,12V Socket,USB port in Bedside Nook	•	•	•	•	•	•	•	•	•	•
Double Power Points : Living Seating Plus USB, Kitchen and Ensuite	•	•	•	•	•	•	•	•	•	•
Reading Lights : Bedroom x2 , Living x2	•	•	•	•	•	•	•	•	•	•
External TV Box : 240V Single Power Point, CIG 12V / Antenna Point Plus Fusion SRX400 Stereo and External Panel Speaker	NA	•	•	•	•	•	•	•	•	•
QFlow Directional Fans x 2	•	•	•	•	•	•	•	•	•	•
Built in Phone Chargers	•	•	•	•	•	•	•	•	•	•
Plumbing										
Multi Lockable Water Filler Box with Fresh Water Tank Change Over Valve	•	•	•	•	•	•	•	•	•	•
Four Water Tank Sensors	•	•	•	•	•	•	•	•	•	•
Two Externally Mounted SailingFlo PumpsUnder chassis	•	•	•	•	•	•	•	•	•	•
Fresh Water Tanks : 2 x95 Litres	•	•	•	•	•	•	•	•	•	•
Grey Water Tank : 1 x 110 Litres	•	•	•	•	•	•	•	•	•	•
Fresh Drinking Water Tank : 1 x 60 Litres	NA	•	•	•	•	•	•	•	•	•
External Shower	•	•	•	•	•	•	•	•	•	•
Mains Tap to A Frame & Mains Pressure	•	•	•	•	•	•	•	•	•	•
Two 9kg Gas Bottles S- Internally mounted	•	•	•	•	•	•	•	•	•	•
External Gas Bayonet Fitting	•	•	•	•	•	•	•	•	•	•
Gas and Electric Hot Water System	•	•	•	•	•	•	•	•	•	•

Specifications

Model	14ft7 (CD) / 14ft9 (RD)	17ft6EW (CD) / 17ft6 (CD) / 17ft8 (RD)	18ft3 (CD) / 18ft5 (RD)	19ft2 (CD) / 19ft4 (RD)	19ft9 (CD) / 19ft11 (RD)	21ft6 (CD)	21ft11 (RD)	21ft11 (RD)	22ft6 (CD)	22ft8 (RD)
Plumbing										
Truma Vario Gas Heater	•	•	•	•	•	•	•	•	•	•
Non Return Valve on the Shower, Vanity Bowl and Kitchen Sink	•	•	•	•	•	•	•	•	•	•
Protection over PVC Drainage Piped	•	•	•	•	•	•	•	•	•	•
Thetford C263CS Ceramic Toilet	14ft7 (CD)	•	•	•	•	•	NA	•	•	NA
Thetford C402-C Left / Right Hand Toilet	14ft9 (RD)	NA	NA	NA	NA	NA	•	NA	NA	•
Ensuite / Bathroom										
Separate Shower & Toilet	•	•	•	•	•	•	•	•	•	•
Fully Moulded One Piece Large Shower Cubicle	•	•	•	•	•	•	•	•	•	•
Sliding or Hinged Door at Ensuite Entrance (Model Dependent)	•	•	•	•	•	•	•	•	•	•
Ceramic Swivel Toilet (Model dependent)	•	•	•	•	•	•	•	•	•	•
Mixer taps Basin , Shower	•	•	•	•	•	•	•	•	•	•
Single Internal Towel Rail	•	•	•	•	•	•	•	•	•	•
Exhaust Fan Hatch in Shower	•	•	•	•	•	•	•	•	•	•
Bathroom Window Above Toilet	•	•	•	•	•	•	•	•	•	•
Qflow Exclusive 2.5kg Front Loader Washing Machine	NA	•	•	•	•	•	•	•	•	•
Exclusive Vanity Mirror with builtin LED Lighting	NA	•	•	•	•	•	NA	NA	•	NA
Wrapped Around OHC over Vanity and Toilet	NA	•	•	•	•	•	NA	NA	•	NA
Kitchen										
Dual Induction Cooktop (Portable)	•	•	•	•	•	•	•	•	•	•
Thetford Duplex MK3 Oven and Grill Combination	•	•	•	•	•	•	•	•	•	•
White Aluminium Kitchen Splashback	•	•	•	•	•	•	•	•	•	•
Three way Filter Tap	•	•	•	•	•	•	•	•	•	•
Qflow 23Litre Microwave Oven	•	•	•	•	•	•	•	•	•	•
Dometic 180 Litre RUC Compressor Fridge 6408 X (Vans 14ft7-19ft4)	•	•	•	•	NA	NA	NA	NA	NA	NA
Dometic 216 Litre RUC Compressor 8408 X (Vans > 19ft9)	NA	NA	NA	NA	•	•	•	•	•	•
Slimline RangeHood	•	•	•	•	•	•	•	•	•	•
Global Eberspacher 3.2KW Air Conditioner	•	•	•	•	•	•	•	•	•	•

Model	14ft7 (CD) / 14ft9 (RD)	17ft6EW (CD) / 17ft6 (CD) / 17ft8 (RD)	18ft3 (CD) / 18ft5 (RD)	19ft2 (CD) / 19ft4 (RD)	19ft9 (CD) / 19ft11 (RD)	21ft6 (CD)	21ft11 (RD)	21ft11 (RD)	22ft6 (CD)	22ft8 (RD)
Living Seating Area										
Padding Over Entry Door and Roof Mounted LED	•	•	•	•	•	•	•	•	•	•
Exclusive Designed Seating with side Leg Support	•	•	•	•	•	•	•	•	•	•
Heavy Duty Vinyl Flooring available in 4 colours	•	•	•	•	•	•	•	•	•	•
Exclusive designed Map/ Magazine and Key holder	•	•	•	•	•	•	•	•	•	•
Tic Cushion supplied with Telescopic table base	NA	• 17ft6 CD	NA	NA	• 19ft11	•	•	•	•	•
Bedroom										
Exclusive Designed Full Size Bedhead	•	•	•	•	•	•	•	•	•	•
Pillow Top Spring Mattress on Slatted Bed Base	•	•	•	•	•	•	•	•	•	•
Roof Hatch with Lights	•	•	•	•	•	•	•	•	•	•
Wardrobe with Bedside Nook and Bottom Drawers	•	•	•	•	•	•	•	•	•	•
Side Tables with Soft LED lighting	•	•	•	•	•	•	•	•	•	•
Built In Phone Charger	•	•	•	•	•	•	•	•	•	•
Cabinetry										
CNC Cabintery through out the Entire Van	•	•	•	•	•	•	•	•	•	•
Modern Slimline Benchtop (Kitchen and Ensuite)	•	•	•	•	•	•	•	•	•	•
White Aluminium Kitchen Splashback	•	•	•	•	•	•	•	•	•	•
Gas Door Struts on Overhead Cupdoors	•	•	•	•	•	•	•	•	•	•
Cutlery Drawer Insert	•	•	•	•	•	•	•	•	•	•
Safety										
Breakaway Safety System	•	•	•	•	•	•	•	•	•	•
Fire Extinguisher	•	•	•	•	•	•	•	•	•	•
Smoke Alarm	•	•	•	•	•	•	•	•	•	•
Gas Detector - Shut Off Solenoid Valve	•	•	•	•	•	•	•	•	•	•
Door - External 4 Pin lock with Security Screen	•	•	•	•	•	•	•	•	•	•
Dexter Anti Sway Control System (DSC)	•	•	•	•	•	•	•	•	•	•

Family Van Layouts

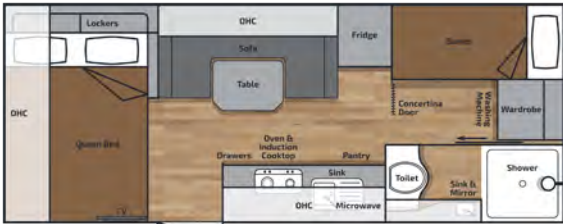

BR1911CDQBEWSCSB

External Body Length: 6105mm
Overall External Length: 8850mm
End Coupling to Outer Spare Tyre

Overall Height: 3200mm
Overall Width: 2500mm

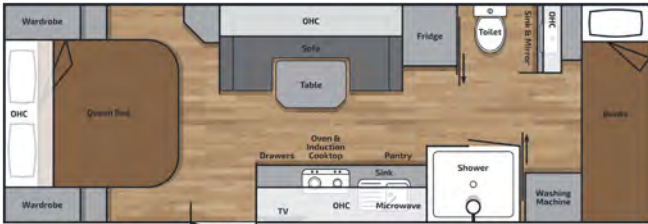

BR2210CDQBSCRB

External Body Length: 6995mm
Overall External Length: 9745mm
End Coupling to Outer Spare Tyre

Overall Height: 3200mm
Overall Width: 2500mm

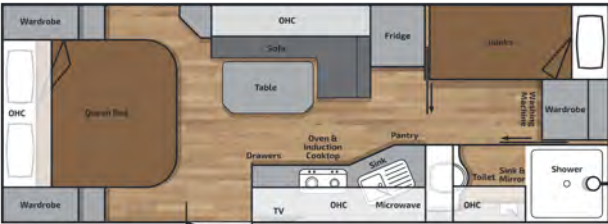

BR216CDQBLLSB

External Body Length: 6590mm
Overall External Length: 9340mm
End Coupling to Outer Spare Tyre

Overall Height: 3200mm
Overall Width: 2500mm

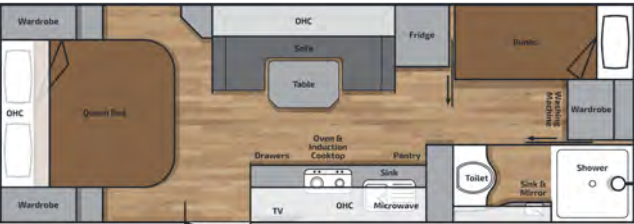

BR226CDQBSCSB

External Body Length: 6895mm
Overall External Length: 9655mm
End Coupling to Outer Spare Tyre

Overall Height: 3200mm
Overall Width: 2500mm

Specifications

Model	19ft11 EW (CD)	21ft6 (CD)	22ft6 (CD)	22ft10 (CD)
Door Position Reference	CD	CD	CD	CD
Standard Seating Arrangement - Centre Door	Side Club	L-Lounge	Side Club	Side Club
Other Seating Options	Dinette or L-Lounge	NA	Dinette or L-Lounge	Dinette or L-Lounge
Dimensions				
External Body Length	6105mm (CD)	6590mm (CD)	6895mm (CD)	6995mm (CD)
External Length (End Coupling to Outer Spare Tyre)	8850mm(CD)	9340mm(CD)	9655mm(CD)	9745mm(CD)
External Height (Variable)	3200mm	3200mm	3200mm	3200mm
External Width includes all protruding fixtures	2500mm	2500mm	2500mm	2500mm
Internal Length	5950mm (CD)	6425mm (CD)	6725mm (CD)	6825mm (CD)
Internal Height	2010mm	2010mm	2010mm	2010mm
Internal Width	2285mm	2285mm	2285mm	2285mm
ATM	4500kgs	4500kgs	4500kgs	4500kgs
Note : Indicative lengths are standard configuration, any additional options or variations could change these figures				
Construction				
Alko Engineered Designed Infill Flat Floor (TRUSS) - Galvanized	•	•	•	•
Options : SuperGal Painted Charcoal or Enduro Paint	o	o	o	o
Alko Chassis Construction:				
Extended Aframe (steel 6" x 2") C450	1800mm	1800mm	1800mm	1800mm
Truss Main Bearers Top: 75x50 Grade C350	•	•	•	•
Truss Main Bearers Bottom: 50x50x3mm Grade C350	•	•	•	•
Aluminium Wall Frame	•	•	•	•
Full Piece Composite Roof : 5 Colour Options	•	•	•	•
22mm XPS Moisture Resistant Insulation between Aluminium Wall Frames	•	•	•	•
PolyHoney Comb Heavy Duty Flooring	•	•	•	•
30mm One Piece XPS Insulated CNC Pre-Fabricated Roof	•	•	•	•
Aluminium Composite Panel : 5 Colour Options	•	•	•	•
Cruisemaster Tandem ATX 4.5T Airbag L3 Manual 12" Electric Brakes	•	•	•	•
DO45 HitchMaster Coupling with Heavy Duty Chains	•	•	•	•

Specifications

Model	19ft11 EW (CD)	21ft6 (CD)	22ft6 (CD)	22ft10 (CD)
Exterior				
265/75 R17 Mud Tyres on Black Rims Includes One Spare Wheel	•	•	•	•
Black Checker Plate , approx 900mm on sides	•	•	•	•
Printed Decals Choice of 5 colours	•	•	•	•
Picnic Table	•	•	•	•
External TV Box	•	•	•	•
External Awning with Mid roller support	•	•	•	•
Electric Awning	o	o	o	o
Double Manual Entry Step	•	•	•	•
Entry Door Grab Handle with Light	•	•	•	•
Bumper Bar 4 arm 45 DEG 46" STD	•	•	•	•
Alko 8" Jockey Wheel	•	•	•	•
Full Width Tunnel Boot	•	•	•	•
Checker Plate Large Toolbox with Double Sliders , Internally Mounted Gas Bottles	•	•	•	•
Carafan Sahara Dust Reduction System	•	•	•	•
Jerry Cans x 2	•	•	•	•
Fusion Panel Speaker Outdoor plus Mounting Bracket, with SRX400 Marine Stereo	•	•	•	•
Safety Dave RV 6" Dash Kit (Dual Camera with Double Woza Scren and Car Wiring)	•	•	•	•
Wireless Reversing Camera	•	•	•	•
Electrical				
Enerdrive eSYS-ICA-SI-03 consisting of				
3000W Inverter /Charger / 100A-12V Pure Sinewave Ouput	•	•	•	•
40Amp DC_DC Charger	•	•	•	•
40Amp Solar Charger x 2	•	•	•	•
Simarine VIA Digital Switch Control Panel	•	•	•	•
4 Water Tank Monitoring Sensors	•	•	•	•
2 x 300Ah B-TEC Enerdrive G2 Lithium Batteries	•	•	•	•
Number of Solar Panels - (200watts each/ model dependant)	X4	X4	X4	X4
Anderson Plug - DCToDC Battery Charging	•	•	•	•
Additional Anderson Plug - Portable Solar Panel	•	•	•	•
Dexter Anti Sway System (DSC)	•	•	•	•
Carafan Sahara Dust Reduction System	•	•	•	•
Starlink Ready: 12V Starlink Cosmo (for Starlink Gen 3)	•	•	•	•
Fusion Radio Apollo 770 Stereo System Plus Fusion Corner Speakers (2 Bedroom and 2 Seating Area)	•	•	•	•
Soft LED strip Lights at : Main Bed Side Tables, Under the Kitchen OHC and Ensuite Cabinetry (Under OHC and KickBoard)	•	•	•	•

Model	19ft11 EW (CD)	21ft6 (CD)	22ft6 (CD)	22ft10 (CD)
Electrical				
Multi Colour Annex Light - Door Side	x3	x3	x3	x3
Multi Colour Annex Light - Driver Side	x1	x1	x1	x1
External Power Point at Picnic Table	•	•	•	•
Reversing Camera	•	•	•	•
Wireles Reversing Camera	o	o	o	o
27" Smart TV (Van size > 19ft2)	•	•	•	•
Tunnel Boot lighting at lockable doors , both sides	•	•	•	•
240V Single Power point,12V Socket,USB port in Bedside Nook	•	•	•	•
Double Power Points : Living Seating Plus USB, Kitchen and Ensuite	•	•	•	•
Reading Lights : Bedroom x2 , Living x 2	•	•	•	•
External TV Box : 240V Single Power Point, CIG 12V / Antenna Point Plus Fusion SRX400 Stereo and External Panel Speaker	•	•	•	•
QFlow Directional Fans x 2	•	•	•	•
Built in Phone Chargers	•	•	•	•
Plumbing				
Multi Lockable Water Filler Box with Fresh Water Tank Change Over Valve	•	•	•	•
Four Water Tank Sensors	•	•	•	•
Two Externally Mounted Water Pump Under chassis	•	•	•	•
Fresh Water Tanks : 2 x95 Litres	•	•	•	•
Grey Water Tank : 1 x 110 Litres	•	•	•	•
Fresh Drinking Water Tank : 1 x 60 Litres	•	•	•	•
External Shower	•	•	•	•
Mains Tap to A Frame & Mains Pressure	•	•	•	•
Two 9kg Gas Bottles S- Internally mounted	•	•	•	•
External Gas Bayonet Fitting	•	•	•	•
Gas and Electric Hot Water System	•	•	•	•
Truma Vario Gas Heater	•	•	•	•
Non Return Valve on the Shower, Vanity Bowl and Kitchen Sink	•	•	•	•
Protection over PVC Drainage Piped	•	•	•	NA
Thetford C263CS Ceramic Toilet	NA	NA	NA	•
Thetford C402-C Left / Right Hand Toilet	•	•	•	NA

Specifications

Model	19ft11 EW (CD)	21ft6 (CD)	22ft6 (CD)	22ft10 (CD)
Ensuite / Bathroom				
Separate Shower & Toilet	•	•	•	•
Fully Moulded One Piece Large Shower Cubicle	•	•	•	•
Sliding or Hinged Door at Ensuite Entrance (Model Dependent)	•	•	•	•
Ceramic Swivel Toilet or Side Toilet (Model dependent)	NA	NA	NA	•
Mixer taps Basin , Shower	•	•	•	•
Single Internal Towel Rail	•	•	•	•
Exhaust Fan Hatch in Shower	•	•	•	•
Bathroom Window Above Toilet	•	•	•	•
Qflow Exclusive 2.5kg Front Loader Washing Machine	•	•	•	NA
Kitchen				
Dual Induction Cooktop (Portable)				
Thetford Duplex MK3 Oven and Grill Combination	•	•	•	•
White Aluminium Kitchen Splashback	•	•	•	•
Three way Filter Tap	•	•	•	•
Qflow 23Litre Microwave Oven	•	•	•	•
Dometic 216 Litre RUC Compressor 8408 X (van > 19ft9)	•	•	•	•
Slimline RangeHood	•	•	•	•
Global Eberspacher 3.5KW Air Conditioner	•	•	•	•
Living Seating Area				
Padding Over Entry Door and Roof Mounted LED	•	•	•	•
Exclusive Designed Seating with side Leg Support	•	•	•	•
Heavy Duty Vinyl Flooring available in 4 colours	•	•	•	•
Exclusive designed Map/ Magazine and Key holder	•	•	•	•
Tic Cushion supplied with Telescopic table base	•	•	•	•
Bedroom				
Exclusive Designed Full Size Bedhead	•	•	•	•
Pillow Top Spring Mattress on Slatted Bed Base	•	•	•	•
Roof Hatch with Lights	•	•	•	•
Wardrobe with Bedside Nook and Bottom Drawers	•	•	•	•
Side Tables with Soft LED lighting	•	•	•	•
Built In Phone Charger	•	•	•	•

Model	19ft11 EW (CD)	21ft6 (CD)	22ft6 (CD)	22ft10 (CD)
Bunk Beds				
Double or Triple Bunks	•	•	•	•
Bed Length	1850mm	1850mm	1850mm	2285mm
Padded Side Support and Ladder	•	•	•	•
240V Single Power point,USB port in Bedside Nook	•	•	•	•
Reading Lights per Bunk	•	•	•	•
Cabinetry				
CNC Cabinetry through out the Entire Van	•	•	•	•
Modern Slimline Benchtop (Kitchen and Ensuite)	•	•	•	•
White Aluminium Kitchen Splashback	•	•	•	•
Gas Door Struts on Overhead Cupdoors	•	•	•	•
Cutlrey Door Insert	•	•	•	•
Safety				
Breakaway Safety System	•	•	•	•
Fire Extinguisher	•	•	•	•
Smoke Alarm	•	•	•	•
Gas Detector	•	•	•	•
Door - External 4 Pin lock with Security Screen	•	•	•	•
Dexter Anti Sway Control System (DSC)	•	•	•	•
Accessories				
Exclusive Millard BackPack	•	•	•	•
Exclusive Millard Umbrella	•	•	•	•
Exclusive Millard Pen set	•	•	•	•
Exclusive Key Ring	•	•	•	•
Exclusive Millard BaseBall Cap	•	•	•	•



Your ticket to *freedom*
since 1947

Unit 1/36-42 Orange Grove Road,
Warwick Farm NSW 2170

02 9829 2055

info@millardrv.com.au

millardcaravans.com.au

@millardcaravans     

Trusted name for 78 years



Your Millard Caravans Dealer: